

**prowarm™**  
**BACKER PRO**  
TILE BACKER BOARDS  
INSTALLATION



**Thermal  
insulation**



**Levelling  
properties**



**Compression  
strength**



**Sound  
reduction**



**Waterproof**



**Light weight  
& easy  
to handle**

## Backer-Pro Tile Backer Board

ProWarm™ Tile backer insulation boards are high quality extruded polystyrene panels which are covered with a fibreglass mesh and a thin cementitious coating on both sides, for use with our under tile heating cables and mats (not suitable for our underwood systems). Available in 6mm, 10mm, 12.5mm, 20mm, 30mm & 50mm thickness.

ProWarm™ Tile Backer Boards are ideal for use in bathrooms and wet-rooms due to their waterproof properties and are also a great insulation board which is perfect for use with underfloor heating systems. (When used on walls a Minimum thickness of 10mm must be used, mechanical fixing at 300mm centres required).

## Using ProWarm Backer-Pro for Underfloor heating

*Suitable for Sticky mat & Loose Cable systems*

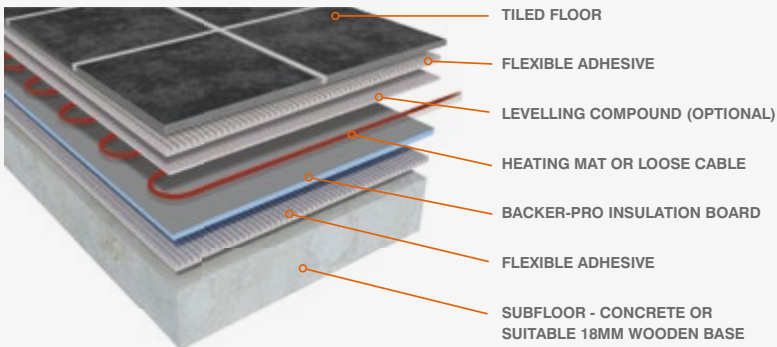

# Installing on floors

## Concrete/Screeded Floors

### Step 1

Ensure floor surface is free of dust and debris and primed with suitable primer. The floor needs to be flat and level (tolerance of between 1-2mm) to ensure a solid adhesion to the backer board.



### Step 2

Allow primer to dry for 1-2 hours (refer to manufacturer's guidelines). Apply flexible tile adhesive to the floor using an 8-10mm notched trowel.

Press the boards firmly onto the tile adhesive ensuring good and even contact with the adhesive across the entire board.



Want more support with your installation here?

Scan the QR code for a step-by-step guide.



## Timber Floors

Tile Backer Boards must be secured in place with flexible tile adhesive and in addition fixed with screws and washers at every 300mm centres. If the timber floor shows signs of movement, then you must secure the floor or reinforce the floor first prior to fixing down the insulated tile backer boards.

## Priming

Please ensure all boards are primed with a suitable primer (as per manufacturer's guidelines) Ensure primer is completely dry before fixing the tiles with a flexible tile adhesive.

## Tanking bathrooms and wetrooms

Please ensure all board joints and screws are sealed and taped using the Prowarm waterproof tape with tape sealing compound. Corner sections of waterproof tape are available for both internal and external corners within your bathroom or wetroom.



### Important:

For tiling either directly over tile backer boards or to embed electric underfloor heating system use a suitable flexible floor tile adhesive. Ensure that all heating mats are fully embedded within the tile adhesive or a suitable self levelling compound.

**NOTE:** Do not use solvent based or pre mixed adhesives. A suitable levelling compound may be applied to embed the heating system prior to tiling if desired.

# Installing on walls

## Solid walls

When fixing onto solid walls, you will need to use adhesive and screws & washers for extra support.

### Adhesive and Mechanical Fixing steps

#### Step 1

*(Brick/Block/Concrete)*

First, Measure Backer-Pro boards and cut to size with a knife or saw.

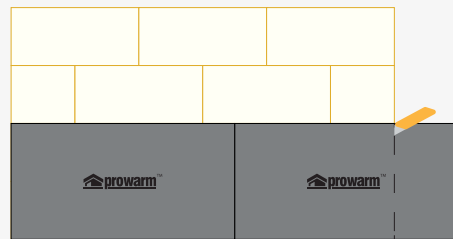

#### Step 2

*(Brick/Block/Concrete)*

Prime the solid walls using a suitable primer.

Spread the adhesive evenly onto the wall using a minimum of an 8mm notch tiler's trowel. Then, put the board up to the wall and press firmly into position before adjusting with a spirit level to ensure that it is both flat and level.

**Keep in mind that the minimum board thickness for a brick, block, or concrete wall installation when solid bed fixing is 6mm.**

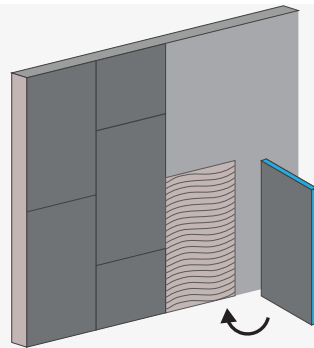

#### Step 3

*(Brick/Block/Concrete)*

Drill 6mm hole through Backer-Pro into the solid wall at every 300mm centres and fit a Rawl plug into these holes.

Using a screwdriver, install the screws and washers into the holes previously drilled.

If used in a bathroom or wetroom, ensure the joints and screws are covered with waterproof tape and tape sealing compound. Scrim tape can be used in non-wet areas.

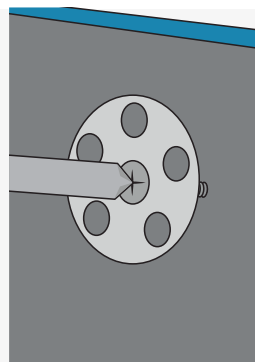

## Stud walls

### Step 1

If stud wall has up to 600mm centres, use a 20mm Backer-Pro board or thicker. If the stud wall has 300mm centres, 10mm & 12.5mm are adequate.

Cross-members are required at every 600mm interval to reinforce the stud wall prior to installing the backer boards.

**300mm Centres**  
10mm-12mm Backer-Pro



**600mm Centres**  
20mm+ Backer-Pro



### Step 2

Use screws and washers every 300mm on each stud. If the studs are at 600mm centres, use 2 rows of 5 fixings on the vertical studs and additional fixings on the cross-members. When at 300mm centres, use 3 rows of 5 fixings.

If used in a bathroom or wetroom, ensure the joints and screws are covered with waterproof tape and tape sealing compound. Scrim tape can be used in non-wet areas.

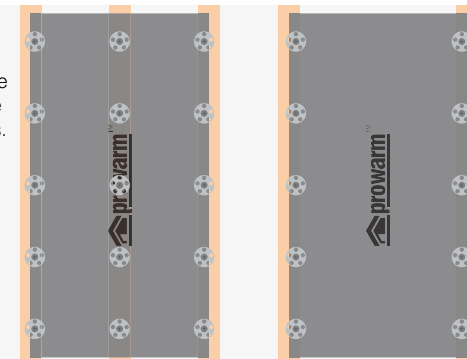

## Tiling walls

If used in a bathroom or wetroom, ensure the joints and screws are covered with waterproof tape and tape sealing compound. Scrim tape can be used in non-wet areas.

Apply a suitable primer to the Backer-Pro boards and allow to dry.

Using a flexible tile adhesive and a notched trowel, apply an even coat of tile adhesive and begin fixing the tiles to the wall.

If you are unsure about any of the steps in this document, please contact ProWarm technical support on:  
**01268 567019**

