



HOMEBASE

10.4" AIR
CIRCULATOR
DESK FAN

INSTRUCTION MANUAL

IMPORTANT: Please read these instructions before using the product and retain for future use.

HHGL Limited, MK9 1BA
HHGL (RO) Limited, D02 X576

SAFETY WARNINGS



Read this information carefully before installation or use of this product. Keep this manual with the product for future reference.

1. This appliance can be used by children aged from 8 years and above, and persons with reduced physical, sensory or mental capabilities, or lack of experience and knowledge, if they have been given supervision or instruction concerning the use of the appliance in a safe way and if they understand the hazards involved.
2. Children should not play with the appliance.
3. Cleaning and maintenance should not be undertaken by children without supervision.
4. Children should be supervised to ensure that they do not play with the appliance.
5. Switch off the power and remove the plug when the appliance is not in use.
6. Do not operate any appliance with a damaged power cord or plug; if the appliance malfunctions; or if it is dropped or damaged in any manner.
7. Do not use outdoors.
8. Do not use any appliance for anything other than its intended use. This product is intended for household use only.
9. This appliance is intended to be plugged in a standard domestic power socket only.
10. Do not misuse the power cord. Never carry the appliance by the power cord or pull to disconnect it from the socket. Instead, grasp the plug and pull to disconnect.
11. Do not attempt to repair, disassemble or modify the appliance yourself. There are no user-serviceable parts.
12. Arrange the power cord away from traffic areas so it will not be tripped over.
13. Do not insert or allow foreign objects to enter the grille openings, as this may cause damage to the appliance and/or injury to the user.
14. Ensure that the fan is switched off from the mains supply

- before removing the guard.
15. Do not insert your fingers in the opening of the guard.
 16. Never use the fan without guard. Do not use the fan if the fan blade is damaged or cracked.
 17. Do not leave hair, tissue, tablecloths, clothes or curtains near all opening of the fan, they could be sucked into the fan and taken within the internal moving parts that could cause injury or damage.
 18. Do not use the fan in wet or damp locations such as bathrooms.
 19. Keep the fan away from pets.
 20. Check the voltage indicated on the rating plate. This product is designed for a 220-240V~ 50-60Hz electric supply. Periodically check the power cord of this fan.
 21. If the power cord is damaged, it must be replaced by the manufacturer, its service agent or similarly qualified persons in order to avoid a hazard.
 22. Place the fan on a flat, firm, steady surface before use.
 23. Do not use this fan near a window or in direct sunlight.
 24. Do not try to disassemble this fan; there are no parts which can be repaired by the user. If you need maintenance, please contact your local store.

TECHNICAL SPECIFICATION

MODEL	SAC-11E
ARTICLE NO.	647427
WATTAGE	35W
WEIGHT	2.8kg
VOLTAGE	220-240V~
FREQUENCY	50-60Hz
BATTERY FOR REMOTE CONTROL	2 × LR03, AAA, 1,5 V

TECHINCAL INFORMATION

Information to identify the model(s) to which the information relates to			
Description	Symbol	Value	Unit
Model identifier(s): SAC-11E			
Maximum fan flow rate	F	19,1	m ³ /min
Fan power input	P	33,1	W
Service value	SV	0,59	(m ³ /min)/W
Standby power consumption	P _{SB}	0,3	W
Fan sound power level	L _{WA}	59,5	dB(A)
Maximum air velocity	C	2,7	meters/sec
Seasonal electricity consumption	Q	10,9	KWh/a
Measurement standard for service value	IEC 60879:1986 + corr:1992		

ICON EXPLANATION



This appliance conforms to relevant directives of The European Community.



The product complies with the applicable UK directives.



Class II appliance.



This marking indicates that this product should not be disposed with other household waste. To prevent possible harm to the environment or human health from uncontrolled waste disposal, recycle it responsibly to promote the sustainable reuse of material resources. To return your used appliance, please use the return and collection systems or contact the store where the appliance was purchased. They can take this product for environmentally safe recycling.

PRODUCT STRUCTURE

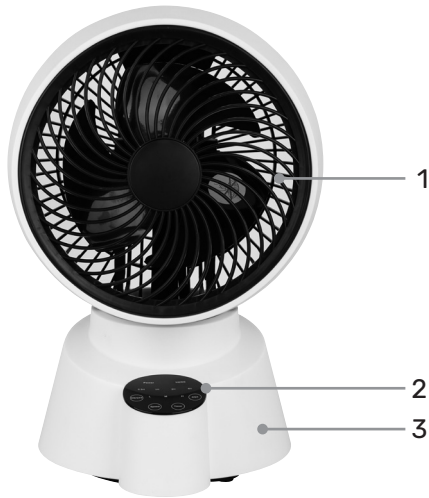

- 1 - Air outlet
- 2 - Control panel
- 3 - Base

ACCESSORIES



Remote control (2 x AAA batteries - not included)

OPERATION

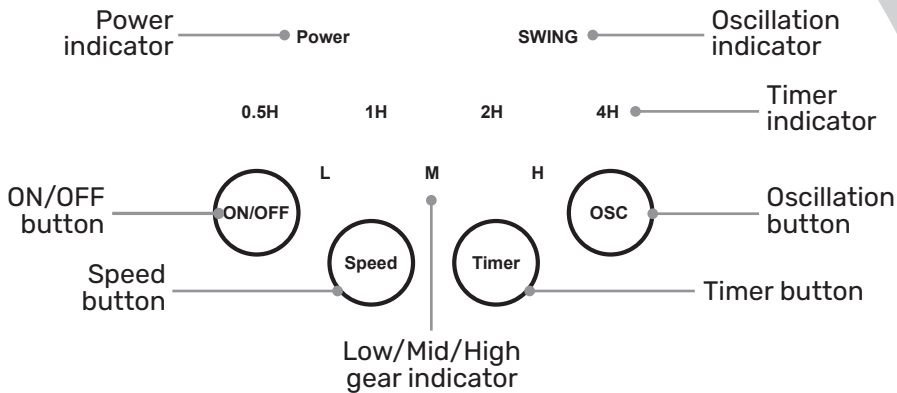

Plug in the power, the power indicator light will turn on.

1. ON/OFF button

To turn ON press the "ON/OFF" button. The midgear indicator light will turn on, and the fan will start operation. To turn OFF press the "ON/OFF" button. The midgear indicator light will turn off, and the fan will stop operation. The power indicator light will always remain on.

2. Speed button

The fan defaults to a midgear speed when it is turned on. You can change the fan speed by touching the "Speed" button.

3. Timer button

Press the "Timer" button repeatedly to set a period after which the fan will turn itself off (From 0.5 hour - 7.5 hours).

4. Oscillation button

When the fan is on, press the "Oscillation" button and the oscillation light will turn on. The fan will then automatically start to move direction. To make the fan into a fixed position again, press the oscillation button.

5. Adjust degree

You can manually adjust this up and down.

6. Remote control

This fan comes with a remote control. You can also control the fan using the push buttons on the fan.

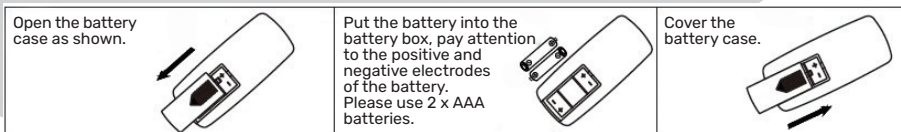

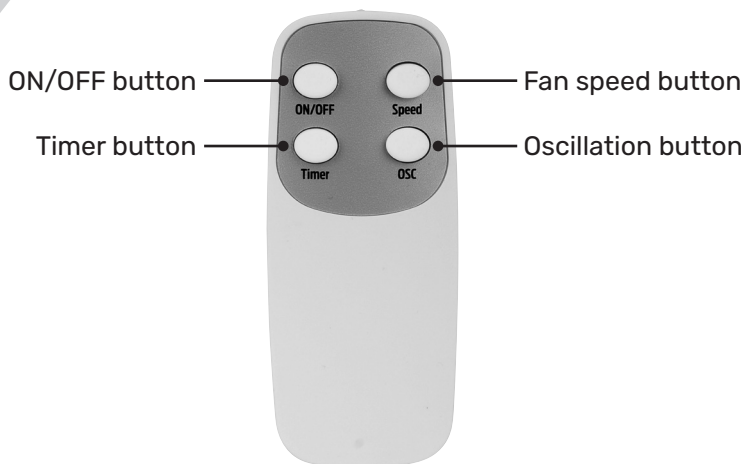

CLEANING

1. Please turn off the fan, and un-plug from the switch before cleaning. When cleaning, use a soft cloth dipped in a little water to wipe the product surface.
2. It is strictly forbidden to wash with alcohol, gasoline and other solvents to avoid yellowing or corrosion of the product surface.

STORAGE

- Store the device and any accessories in a dry, well-ventilated place.
- In case of longer periods without operation, protect the device and its accessories against soiling and corrosion.

PLUG REPLACEMENT

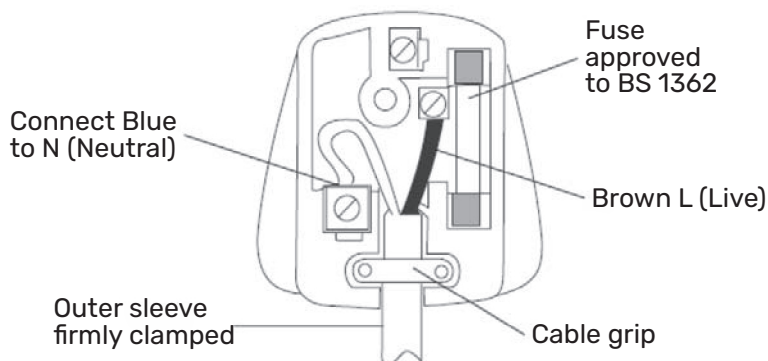

If you need to replace the fitted plug, then follow the instructions below.

⚠ WARNING! The wires in the mains lead are coloured in accordance with the following code:

Blue – Neutral
Brown – Live

As the colour of the wire in the mains lead of this appliance may not correspond with the coloured marking identifying the terminals in your plug, proceed as follows:

The blue wire must be connected to the terminal marked N or coloured black.

The brown wire must be connected to the terminal marked L or coloured red.

⚠ WARNING! Never connect live or neutral wires to the earth terminal of the plug. Only fit an approved BS 1363 or BS 1363/A plug and correctly rated BS 1362 13 Amp fuse. If in doubt, consult a qualified electrician.

NOTE: If a moulded plug is fitted and has to be removed, take great care in disposing of the plug and severed cable; it must be destroyed to prevent it being accidentally plugged into a power socket.

WARRANTY

This product is covered by a 2 year warranty.

The warranty covers any manufacturing defect in materials, workmanship and finish.

Any claim under this warranty must be made by going to your nearest Homebase store, taking your proof of purchase with you, and claims must be made within 2 years of the date of purchase.

We will offer you a free repair of the item where this is possible, or a replacement or a refund. Your statutory rights remain unaffected, in particular, any rights you may have under the Consumer Rights Act 2015.

This warranty is given by:

HHGL Limited, MK9 1BA; HHGL (ROI) Limited, D02 X576

Please note: This warranty does not apply to products misused or neglected and only covers domestic use. It does not apply to commercial use of the product.