



# HOMEBASE

38"  
TOWER FAN

## INSTRUCTION MANUAL

**IMPORTANT:** Please read these instructions before using the product and retain for future use.

HHGL Limited, MK9 1BA  
HHGL (ROI) Limited, D02 X576

# SAFETY WARNINGS



Read this information carefully before installation or use of this product. Keep this manual with the product for future reference.

1. This appliance can be used by children aged from 8 years and above, and persons with reduced physical, sensory or mental capabilities, or lack of experience and knowledge, if they have been given supervision or instruction concerning the use of the appliance in a safe way and if they understand the hazards involved.
2. Children should not play with the appliance.
3. Cleaning and maintenance should not be undertaken by children without supervision.
4. Children should be supervised to ensure that they do not play with the appliance.
5. Switch off the power and remove the plug when the appliance is not in use.
6. Do not operate any appliance with a damaged power cord or plug; if the appliance malfunctions; or if it is dropped or damaged in any manner.
7. Do not use outdoors.
8. Do not use any appliance for anything other than its intended use. This product is intended for household use only.
9. This appliance is intended to be plugged in a standard domestic power socket only.
10. Do not misuse the power cord. Never carry the appliance by the power cord or pull to disconnect it from the socket. Instead, grasp the plug and pull to disconnect.
11. Do not attempt to repair, disassemble or modify the appliance yourself. There are no user-serviceable parts.
12. Arrange the power cord away from traffic areas so it will not be tripped over.
13. Do not insert or allow foreign objects to enter the grille openings, as this may cause damage to the appliance and/or injury to the user.
14. Ensure that the fan is switched off from the mains supply before removing the guard.

15. Do not insert your fingers in the opening of the guard.
16. Never use the fan without the guard. Do not use the fan if the fan blade is damaged or cracked.
17. Do not leave hair, tissue, tablecloths, clothes or curtains near any opening of the fan, they could be sucked into the fan and taken within the internal moving parts, which could cause injury or damage.
18. Do not use the fan in wet or damp locations such as bathrooms.
19. Keep the fan away from pets.
20. Check the voltage indicated on the rating plate. This product is designed for a 220-240V~ 50Hz electric supply. Periodically check the power cord of this fan.
21. If the power cord is damaged, it must be replaced by the manufacturer, its service agent or similarly qualified persons in order to avoid a hazard.
22. Place the fan on a flat, firm, steady surface before use.
23. Do not use this fan near a window or in direct sunlight.
24. Do not try to disassemble this fan; there are no parts which can be repaired by the user. If you need maintenance, please contact your local store.

# TECHNICAL SPECIFICATION

MODEL	LG38-01R
ARTICLE NO.	647424
WATTAGE	50W
WEIGHT	2.5kg
VOLTAGE	220-240V~
FREQUENCY	50Hz

# TECHINICAL INFORMATION

Information to identify the model(s) to which the information relates to			
Description	Symbol	Value	Unit
Model identifier(s): 647424			
Maximum fan flow rate	F	27,73	m <sup>3</sup> /min
Fan power input	P	40,8	W
Service value	SV	0,68	(m <sup>3</sup> /min)/W
Standby power consumption	P <sub>SB</sub>	0,18	W
Fan sound power level	L <sub>WA</sub>	54,68	dB(A)
Maximum air velocity	C	2,96	metres/sec
Measurement standard for service value	EN IEC 60879:2019		

# ICON EXPLANATION



This appliance conforms to relevant directives of The European Community.



The product complies with the applicable UK directives.



Class II appliance.



This marking indicates that this product should not be disposed with other household waste. To prevent possible harm to the environment or human health from uncontrolled waste disposal, recycle it responsibly to promote the sustainable reuse of material resources. To return your used appliance, please use the return and collection systems or contact the store where the appliance was purchased. They can take this product for environmentally safe recycling.

# PRODUCT STRUCTURE

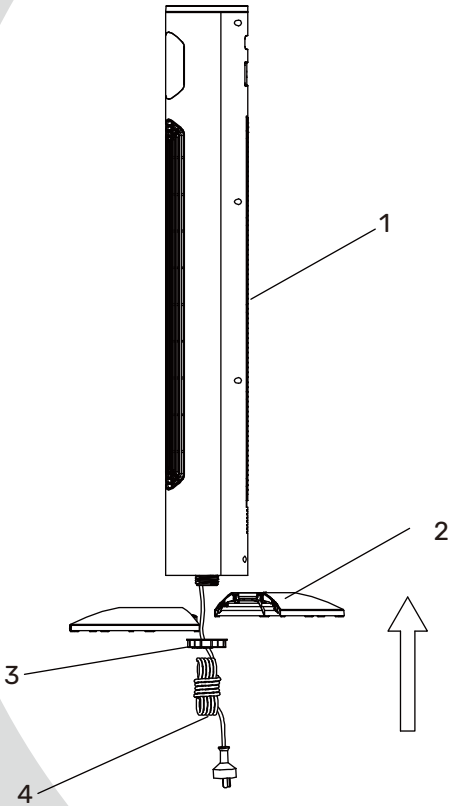

- 1. Main body
- 2. Base
- 3. Adjusting plastic screw
- 4. Power cord and plug

## ASSEMBLY

1. To assemble the base (2) to the main body (1), detach the adjusting plastic screw (3) from the main body, as illustrated.

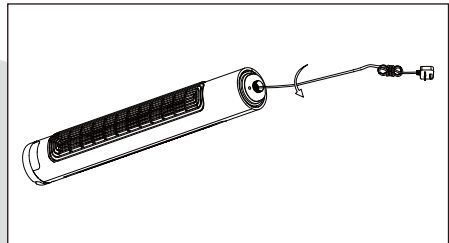

2. Attach the base (2) to the main body (1) and ensure all holes align, so parts fix together correctly, as illustrated.

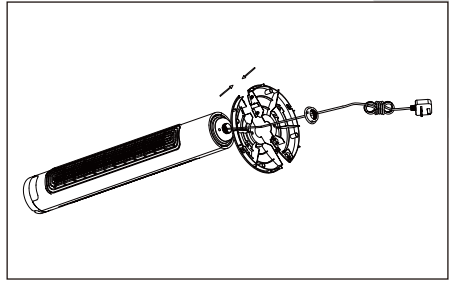

3. Secure the main body (1) and base (2) together by rotating the adjusting plastic screw clockwise, as illustrated.

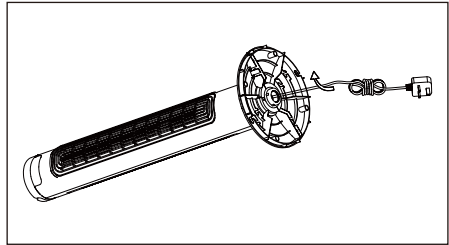

4. Insert the power cord (4) into the hole on the base (2) and plug into the power supply, as illustrated.

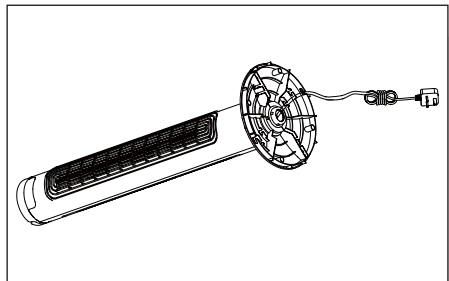

# REMOTE CONTROL

1. For your convenience, the buttons on the control panel on top of the fan operate the same functions as the remote control. Every press of a button will be acknowledged with a beep sound.
2. Handle the remote control carefully; do not drop or throw it. For the best signal reception, point the remote control towards the signal receiver at the top of the appliance. Ensure that nothing is obstructing the path of the signal.

## BATTERY REPLACEMENT

If the battery in the remote control needs replacing, please replace it as follows:

Push the locking tab to one side and pull out the battery holder, as illustrated.

Remove the old battery from the remote control and insert a new one of the same type, observing the battery polarity.

Push the battery holder with the battery back into the remote control.

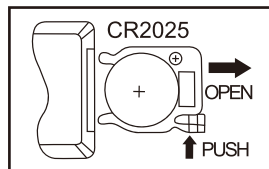
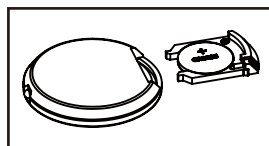



# OPERATION

## Switching on/off

Press the  POWER button to switch on the fan. It will start blowing air. Press the button again to switch off the fan.

## Speed selection

Press the SPEED button, repeatedly, to select the desired fan speed: Low (1), Medium (2) or High (3)

## Mode selection

Press the MODE button, repeatedly, to select the desired mode: NORMAL , NATURAL  or SLEEP .

- **NORMAL:** In this mode the fan operates at a constant speed. The “Normal” mode indicator is illuminated.
- **NATURAL:** In this mode the fan simulates a natural breeze by cycling on and off, as in nature. The “Natural” mode indicator is illuminated.
- **SLEEP:** In this mode the fan simulates a soft, gentle breeze, suitable for rest time. The “Sleep” mode indicator is illuminated.

## Oscillation/swing

Press the OSC button to activate the oscillation function for widespread breeze distribution. Press this button to stop oscillation when the airflow is in the desired direction.

## Timer setting

Press the TIMER button to set the timer for the fan to switch off automatically after a set time. Every press of the TIMER button increases the set time by 30 minutes, up to a total of 7.5 hours.

## Temperature

The current ambient temperature is shown on the LED display.

## CLEANING

1. Always unplug the fan before cleaning.
2. Use a soft damp cloth with a mild soap to clean the fan. DO NOT use abrasive cleaners.
3. DO NOT immerse the fan in water and never allow water to drop into the motor component.
4. DO NOT use petrol, thinner or other chemicals to clean the fan.

## STORAGE

- Store the appliance and any accessories in a dry, well-ventilated place.
- In case of longer periods without operation, protect the appliance and its accessories against soiling and corrosion.

# PLUG REPLACEMENT

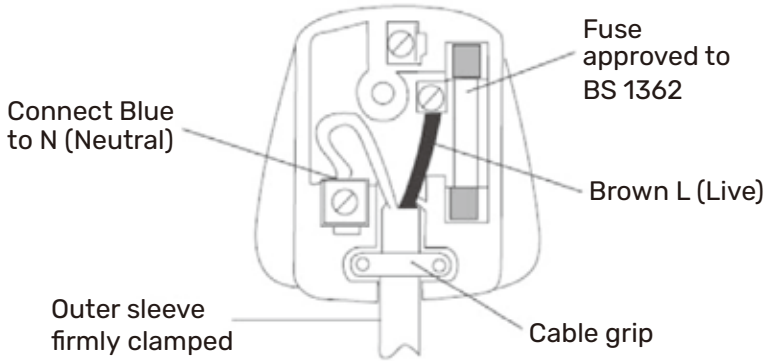

If you need to replace the fitted plug, then follow the instructions below.

**⚠ WARNING!** The wires in the mains lead are coloured in accordance with the following code:

Blue – Neutral  
Brown – Live

As the colour of the wire in the mains lead of this appliance may not correspond with the coloured marking identifying the terminals in your plug, proceed as follows:

The blue wire must be connected to the terminal marked N or coloured black.

The brown wire must be connected to the terminal marked L or coloured red.

**⚠ WARNING!** Never connect live or neutral wires to the earth terminal of the plug. Only fit an approved BS 1363 or BS 1363/A plug and correctly rated BS 1362 3 Amp fuse. If in doubt, consult a qualified electrician.

**NOTE:** If a moulded plug is fitted and has to be removed, take great care in disposing of the plug and severed cable; it must be destroyed to prevent it being accidentally plugged into a power socket.

## WARRANTY

This product is covered by a 2 year warranty.

The warranty covers any manufacturing defect in materials, workmanship and finish.

Any claim under this warranty must be made by going to your nearest Homebase store, taking your proof of purchase with you, and claims must be made within 2 years of the date of purchase.

We will offer you a free repair of the item where this is possible, or a replacement or a refund. Your statutory rights remain unaffected, in particular any rights you may have under the Consumer Rights Act 2015.

This warranty is given by HHGL Limited, MK9 1BA; HHGL (ROI) Limited, D02 X576

Please note: This warranty does not apply to products misused or neglected and only covers domestic use. It does not apply to commercial use of the product.