



1400W WET & DRY VACUUM CLEANER

Item No. 585802

Model No. MWW806-20L-1400WA



INSTRUCTION MANUAL

Please read these instructions fully before starting assembly.

HHGL Limited, MK9 1BA HHGL (ROI) Limited, D02 X576

November 20

CONTENTS

General safety warnings	3
Symbols	5
Parts list	6
Intended use	7
Assembly	7
Operation	12
Maintenance	15
Technical data	18
Accessories	18
Troubleshooting	19
Warranty	20
Environmental protection	20

GENERAL SAFETY WARNINGS

 **WARNING: Read all safety warnings and all instructions.** Failure to follow the warnings and instructions may result in electric shock, fire and/or serious injury.

Save all warnings and instructions for future reference.

This appliance can be used by children aged 8 years and above, and persons with reduced physical, sensory, or mental capabilities, or lack of experience and knowledge, if they have been given supervision or instruction concerning the use of the appliance in a safe way and understand the hazards involved. Children must not play with the appliance. Cleaning and maintenance must not be undertaken by children without supervision.

If the supply cord is damaged, it must be replaced by the manufacturer, its service agent or similarly qualified persons in order to avoid a hazard.

- **IMPORTANT:** Read the operating instructions before assembling and using for the first time.
- Check that the mains voltage is the same as the mains voltage specified on the rating plate.
- Pull out the power plug in the following circumstances: Whenever the appliance is not in use, before opening the appliance and before all cleaning and maintenance work.
- Never clean the appliance with solvents.
- Never pull the plug out of the socket by pulling the cable.
- Never leave the appliance unattended when ready for use.
- Keep away from children and pets.
- Take care to ensure that the power cable does not get damaged by being run over, crushed, pulled or similar.
- Do not use the appliance if the power cable is in less than

perfect condition.

- If the power cable has to be replaced, the replacement must comply with the design specifications of the manufacturer.
- Never vacuum the following: Burning matches, smoldering ash and cigarette butts, combustible, caustic, flammable or explosive substances, vapour or liquids.
- This appliance is not suitable for vacuuming dust, which can be harmful to health.
- Store the appliance in a dry indoor location.
- Never use the appliance if it is damaged.
- Have the appliance serviced only by an authorised after sales service outlet.
- Use the appliance only to carry out work for which it has been designed.
- Take extra care when cleaning steps.
- Use only genuine accessories and spare parts.

SYMBOLS



Warning!



Read the operator's manual



Waste electrical products must not be disposed of with household waste. Please recycle where facilities exist. Check with your local authority or retailer for recycling advice.



Class II appliance



The product complies with the applicable European Directives and an evaluation method of conformity for these directives was done.

PARTS LIST

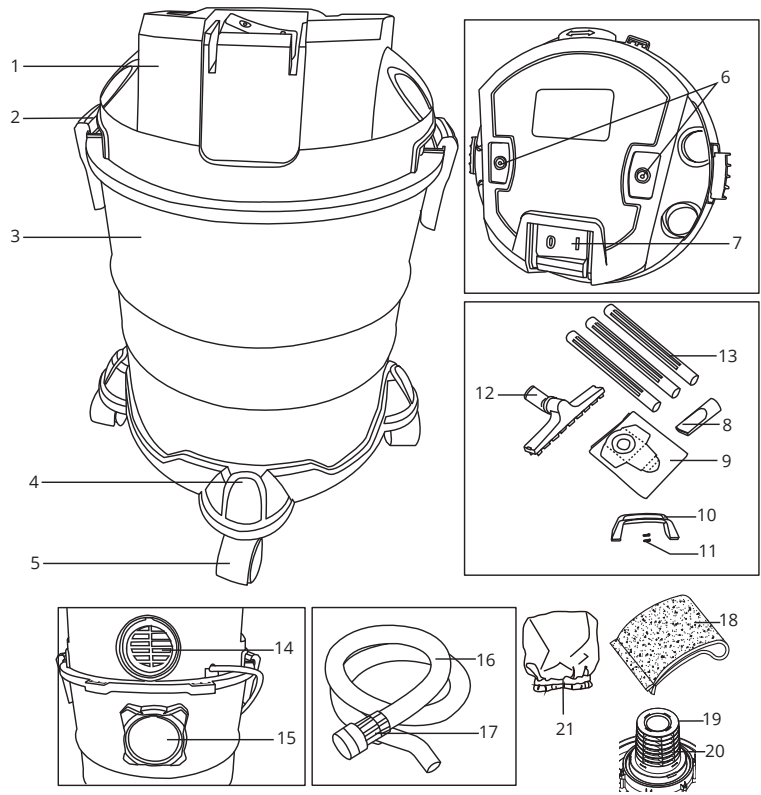

1.	Appliance head	12.	Floor tool
2.	Side locking latch x 2	13.	Extension tube x 3
3.	Tank	14.	Flexible blow hose outlet
4.	On board storage holders	15.	Flexible suction hose outlet
5.	Wheels x 4	16.	Flexible hose
6.	Groove for handle x 2	17.	Flexible hose connection
7.	On/off switch	18.	Foam filter
8.	Crevice nozzle	19.	Filter basket
9.	Paper dirt bag	20.	Floating safety valve
10.	Carry handle	21.	Cloth filter
11.	Screws for carry handle x 2		

INTENDED USE

The wet and dry vacuum cleaner is designed for wet and dry vacuuming using the appropriate filter. This product is suitable for private domestic use, i.e cleaning dirt, debris and liquids from garages, workshops, courtyards, patios and garden environment.

This product is not suitable for the vacuuming of combustible, explosive or harmful substances. The product is to be used only for its prescribed purpose. Any other use is deemed to be a case of misuse. The user/operator and not the manufacturer will be liable for any damage or injuries of any kind caused as a result of this.

ASSEMBLY



WARNING:

- To prevent serious injury from accidental operation, turn the power switch of the vacuum off and unplug the appliance from its electrical outlet before performing any procedure in this section.
- Before you connect the vacuum to a mains supply, make sure that the data on the rating/technical label is identical to the mains data.

Assemble the wheels

- 1) Remove the appliance head from the tank by unlocking the side locking latch pulling them outwards, then upwards. Then turn the tank upside down. (See Fig. A1, A2)

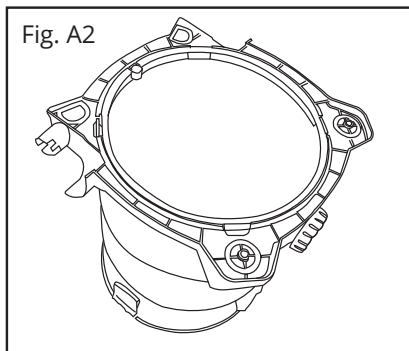
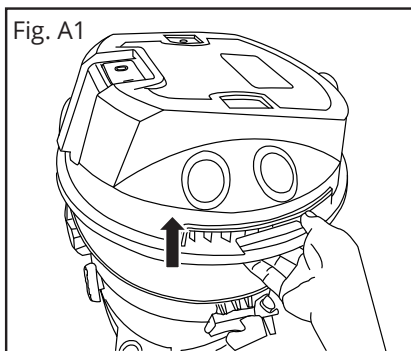

- 2) Fit the wheel by inserting the mounting pin into the designated mounting hole on the underside of the base. Firmly push the wheels into the mounting holes. (See Fig. A3)
- 4) When all 4 wheels are fitted, turn the product the right way up, and re-attach the appliance head ensuring you align the notches on the ridge of the tank lip with the side locking latches, and secure the side locking latch in position. (See Fig. A4, A5)

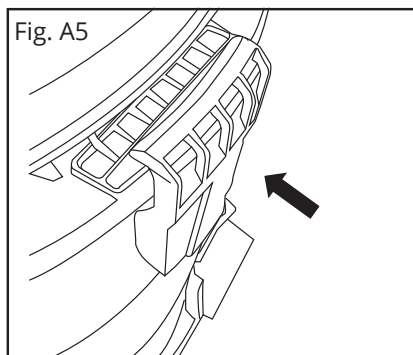
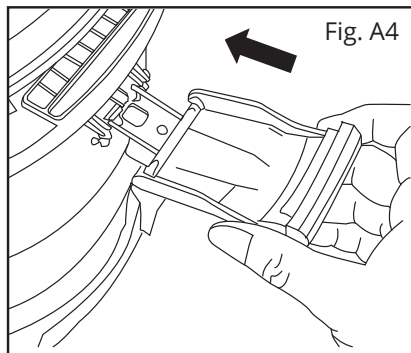
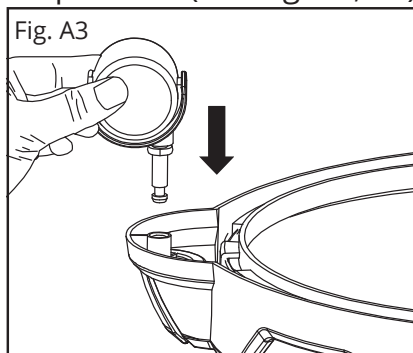

Assemble the carry handle

- 1) Place the carry handle in the grooves for the handle on the appliance head so that they are fitted and align correctly. (See Fig. B1)
- 2) Using a Phillips screwdriver (not supplied), insert and secure the screws for the carry handle through each side of the handle until secure. (See Fig. B2)

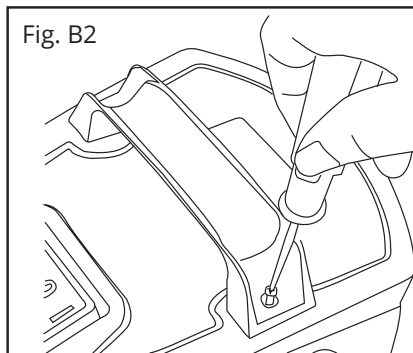
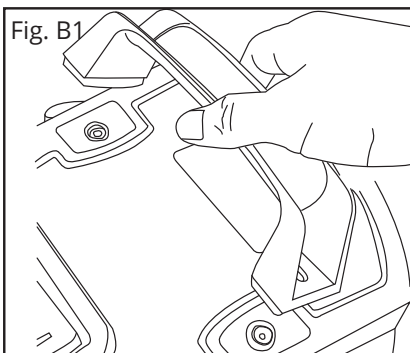

Assemble the filter



WARNING: Never use the wet/dry vacuum cleaner without a filter!



WARNING: Always ensure that the filters are properly secure!

Assemble the cloth filter for dry vacuuming



WARNING: Never use the vacuum without the cloth filter. Check that the cloth filter is securely fitted at all times.

This vacuum cleaner is fitted with a cloth filter used for dry vacuuming only. (See Fig. C1)

Assemble the foam filter for wet vacuuming



WARNING: Never use the vacuum before wet vacuuming without a foam filter. Check that the filter is securely fitted at all times.

- 1) Remove the appliance head from the tank and place the appliance head upside down onto a flat surface, or on its side due to the position of the carry handle.
- 2) Slip the foam filter over the filter basket. (See Fig. C2) Ensure the foam filter covers the full filter basket.
- 3) Re-assemble the appliance head back onto the tank, and secure the side locking latch.

NOTE:

- The foam filter is only suitable for WET vacuuming.
- Always unplug the appliance after use, and before cleaning or changing the filters or accessories.

IMPORTANT: Regularly clean the foam filter and allow it to dry before resuming vacuuming.

IMPORTANT: DO NOT use the cloth filter for WET vacuuming. Always remove the cloth filter before WET vacuuming.

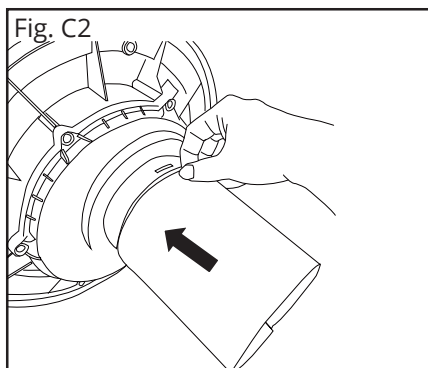
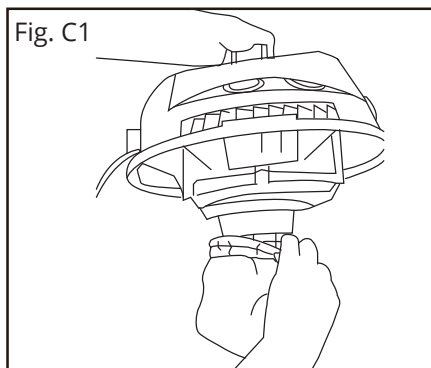

Assemble the paper dirt bag

For vacuuming fine, dry dirt, it is recommended that you fit the paper dirt bag. Slip the paper dirt bag over the vacuuming hole. The paper dirt bag is suitable for dry-vacuuming only. The dirt bag makes it easier to dispose of the sucked-in dust. (See Fig. C3)

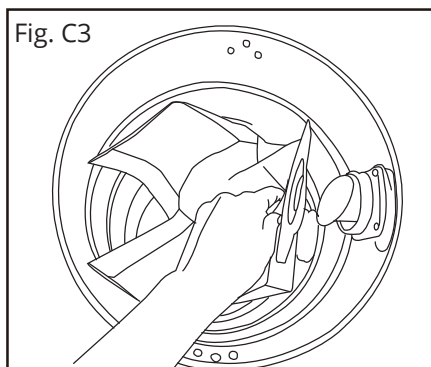

Assemble the flexible hose

Connect the flexible hose to the flexible hose outlet depending on the application required:

- Vacuuming

Connect the flexible hose to the flexible suction hose outlet on the tank by inserting the hose into the outlet and aligning the

locking pin on the end of the flexible hose with the groove on the outlet. Turn the flexible hose to the left to secure the hose into position. (See Fig. D1)

- Blowing

Connect the flexible hose to the flexible blow hose outlet on the appliance head by inserting the hose into the outlet and aligning the locking pin on the end of the flexible hose with the groove on the outlet. Turn the flexible hose to the left to secure the hose into position. (See Fig. D2)

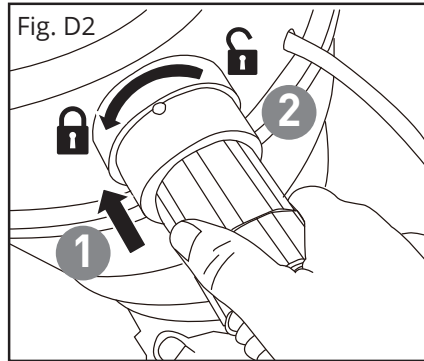
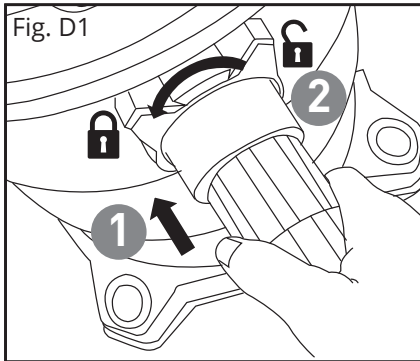

Fitting the extension tubes and tools

- 1) To fit the extension tube to the end of the flexible hose, apply the larger opening end of the extension tube over the end of the flexible hose. (See Fig. E1)
- 2) Connect the three extension tubes one by one. (See Fig. E2)
- 3) For vacuuming, either the floor tool, or crevice nozzle can be added to the end of the telescopic extension tube by simply pushing them onto the extensions tube. (See Fig. E3, E4)

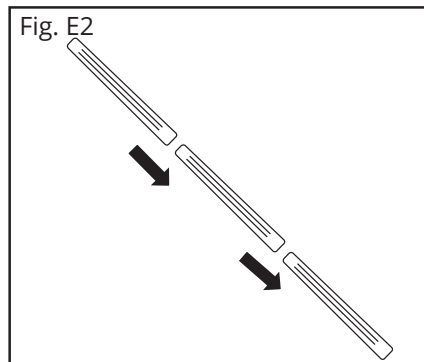
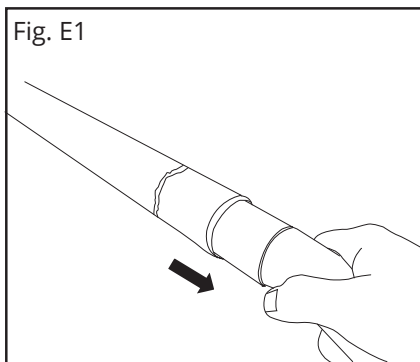

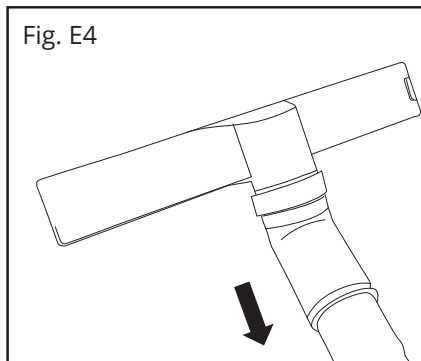
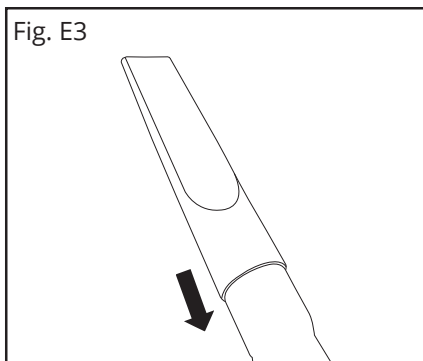

OPERATION

Switching on and off

To start the machine, depress the on/off switch to 'I'.

To switch off, depress the on/off switch to 'O'. (See Fig. F)

NOTE: When the maximum filling capacity is reached, switch off the machine immediately. Before opening and emptying, always pull the plug from the socket.

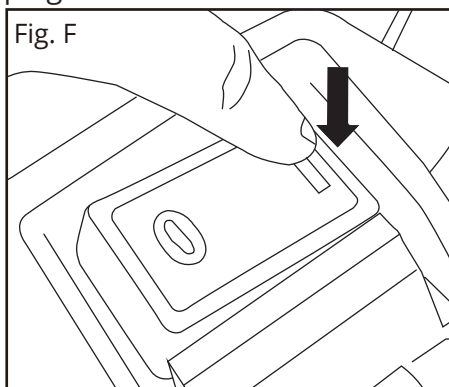

Dry vacuuming

WARNING: DO NOT use the foam filter for dry vacuuming applications.

NOTE: It is recommended to use paper dirt bag for dry vacuuming applications, even though the Wet & Dry Vacuum can normally be used without the paper dirt bag.

- 1) Ensure the tank is completely dry and free from dust and dirt.

- 2) Ensure the cloth filter is fitted already. If not, install the cloth filter first (See Fig. G1). Ensure you have already fitted the flexible hose, extension tube, and, if required, the floor tool or crevice nozzle for dry vacuuming applications.

IMPORTANT: ALWAYS ensure the cloth filter is securely fitted before starting the vacuum cleaner.

- 3) Fit the paper dirt bag in the tank if required. (See Fig. G2)

NOTE: The paper dirt bag is only for dry vacuum cleaning.

- 4) Plug the power cord into the mains power outlet and turn on.
- 5) To commence vacuum mode operation, press the 'I' on the ON/OFF switch. (See Fig. F)
- 6) To turn off vacuum mode, press the 'O' on the ON/OFF switch.

 **WARNING:** Check the cloth filter regularly for any blockages which may reduce the suction and cause motor overheating. Clean the cloth filter (following the cleaning instructions) and empty the tank if required.

 **WARNING:** Check the tank regularly and empty the waste collected when it is about 2/3 full.

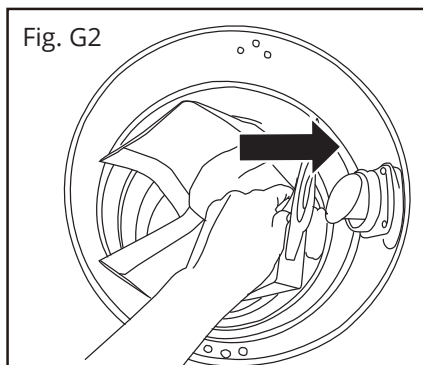
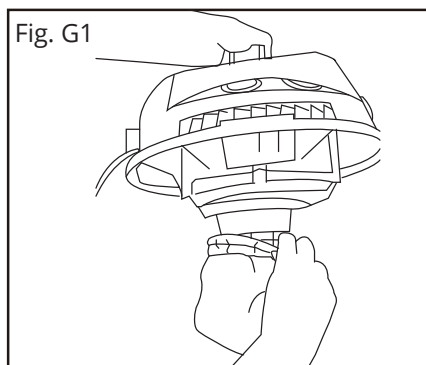

Wet vacuuming

- 1) Ensure the tank is completely dry and free from dust and dirt.
- 2) Only use the foam filter for wet vacuuming applications (See Fig. C2). Ensure you have already fitted the flexible hose, extension tubes, and, if required, the floor tool or crevice nozzle for wet vacuuming applications.

IMPORTANT: Ensure the foam filter is securely fitted before

starting the Vacuum.

- 3) Plug the power cord into the mains power outlet and turn on.
- 4) To commence vacuum mode operation, press the 'I' on the ON/OFF switch. (See Fig. F)
- 5) To turn off vacuum mode, press the 'O' on the ON/OFF switch.

NOTE: When wet vacuuming, the floating safety valve closes when the maximum tank level is reached. In doing so, the suction noise of the vacuum will change and become louder. When this happens, you must switch off the vacuum and empty the tank.



WARNING: The Wet & Dry Vacuum is not suitable for the vacuuming of combustible liquids. Danger of explosion and fire! Do not vacuum flammable or explosive fluids; for example, petrol, oil, alcohol, solvents. Do not vacuum hot or burning dust. Do not operate the machine in rooms where the danger of an explosion exists.

- 6) To empty the tank, firstly ensure you are in an area where you plan to disperse the waste water.
- 7) Remove the appliance head from the tank and empty the tank completely.

Blowing function



WARNING:

- Wear a dust mask and eye protection (PPE) if blowing creates dust that might be inhaled.
- Keep bystanders clear from blowing debris.

CAUTION: Any material left in the tank may be blown out, causing injury.

- 1) Make sure the tank is empty and completely dry before using it as a blower.
- 2) Fit the flexible hose to the flexible blow hose outlet. Refer to ASSEMBLE THE FLEXIBLE HOSE.
- 3) Attach extension tube if required.
- 4) Before turning ON, ensure you are firmly holding the end

of the flexible hose, or extension tube if added.

- 5) Press the 'I' on the ON/OFF Switch to turn ON. To turn OFF, press the 'O' on the ON/OFF switch.

MAINTENANCE

 **WARNING!** You must pull out the power plug from the mains outlet before commencing any cleaning, maintenance or inspection work procedures on the appliance.

- Keep all safety devices, air vents and the motor housing and appliance head free of dirt and dust.
- We recommend that you clean and dry the appliance immediately after each use.

Cleaning the appliance head

- Clean the appliance head regularly with a damp cloth and mild detergent, followed by wiping down and drying before storing away.
- Do not submerge the appliance head in water or allow water to enter the appliance head.
- Do not use cleaning agents or solvents. These may be aggressive to the plastic parts on the appliance.

Cleaning the tank

The tank can be cleaned with a damp cloth and soap or rinsed under running water, depending on the amount of dirt. Wipe down and dry before storing away.

Cleaning the cloth filter

Clean the cloth filter regularly by carefully patting it and cleaning it with a fine brush or hand brush (not supplied), or wash the cloth filter with clean water. The cloth filter can be used again after drying.

Cleaning the foam filter

- Clean the foam filter with a little soap under running water.
- Allow the foam filter to completely air-dry before reinstalling or storing away. Do not wring dry.

Check the floating safety valve

Check the floating safety valve often to ensure it moves freely within the filter basket. To do this, take the appliance head by the handle and tip it carefully so that the filter basket is facing upwards. The floating safety valve should move freely up and down.

General maintenance

Before each use, inspect the general condition of the appliance and check for the following:

- Loose hardware or screws.
- Misalignment or binding of moving parts.
- Damaged or electrical wiring.
- Check filters are securely fitted.
- Damaged or cracked tank.
- Any other condition that may affect safe operation.

If the supply cord is damaged, it must be replaced by the manufacturer, its service agent or similarly qualified persons in order to avoid a hazard.

Storage

Store the vacuum cleaner with its accessories indoors, especially in a cool dry location, and out of the reach of children and animals. You can place the floor tool and crevice nozzle onto the onboard storage/holders on the appliance head, and slot the extension tube onto anyone of the onboard storage/holders on the base of the vacuum cleaner. (See Fig. H1, H2)

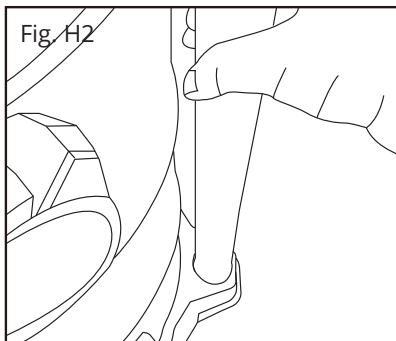
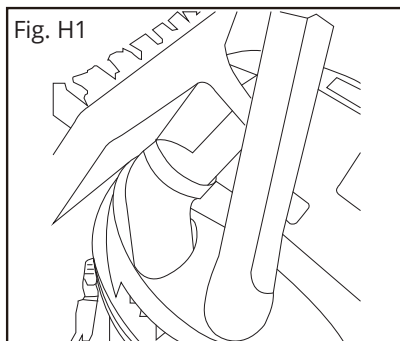

Replace BS plug

If you need to replace the fitted plug then follow the instructions below.

IMPORTANT

The wires in the mains lead are coloured in accordance with the following code:

Blue = Neutral

Brown = Live

As the colours of the wires in the mains lead of this appliance may not correspond with the coloured markings identifying the terminals in your plug, proceed as follows: The blue wire must be connected to the terminal marked 'N'. The brown wire must be connected to the terminal marked 'L'.

Never connect live or neutral wires to the earth terminal of the plug. Only fit an approved BS1363/A plug and the correct rated current fuse which is used in the plug.

Note: If a moulded plug is fitted and has to be removed, take great care in disposing of the plug and severed cable; it must be destroyed to prevent engaging into a socket.

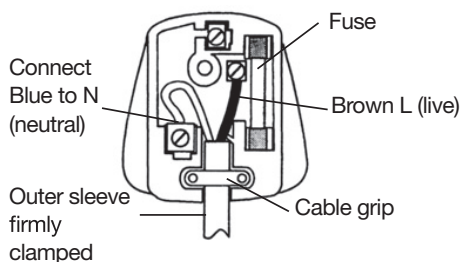

TECHNICAL DATA

Model	MWW806-20L-1400WA
Rated voltage	220-240V~50/60Hz
Rated input power	1400W
Hose length	1.5m
Suction hose diameter	Ø32mm
Capacity	20L
Machine weight	5.6kg

ACCESSORIES

Small wheels	x 4
Crevice nozzle	x 1
Paper dirt bag	x 1
Foam filter	x 1
Flexible hose	x 1
Floor tool	x 1
Cloth filter	x 1
Extension tube	x 3

We recommend that you purchase your accessories listed in the above list from the same store that sold you the tool. Refer to the accessory packaging for further details. Store personnel can assist you and offer advice.

TROUBLESHOOTING

 **WARNING!** You must pull out the power plug from the mains outlet before commencing any cleaning, maintenance or inspection work procedures on the appliance. Reconnect power to the machine when safe to do so.

Problem	Possible cause	Solution
Suction decreases	Blocked flexible hose	Gently remove obstruction using a long stick.
	Blocked extension tube	Gently remove obstruction using a long stick.
	Tank has reached 2/3 full or is completed full with waste and debris	Completely empty tank.
Noise of vacuum changes and suction decreases	Cloth filter is dirty and clogged	Clean the cloth filter regularly by carefully patting it and cleaning it with a fine brush or hand brush (not supplied). If suction continues to decrease after cleaning the bag, replace with a new cloth filter.
	Foam filter is dirty and clogged	Clean the foam filter with a little detergent under running water. If suction continues to decrease after cleaning the filter, replace with a new foam filter.
	Tank has reached 2/3 full or is completed full with waste and debris	Completely empty tank.
	Wrong filter has been used	Use the correct filter for the application at hand. Follow all warnings and instructions provided in this user manual.

WARRANTY

This product is covered by a 1 year warranty.

The warranty covers any manufacturing defect in materials, workmanship and finish.

Any claim under this warranty must be made by going to your nearest Homebase store, taking your proof of purchase with you, and claims must be made within 1 year of the date of purchase.

We will offer you a free repair of the item where this is possible, or a replacement or a refund. Your statutory rights remain unaffected, in particular any rights you may have under the Consumer Rights Act 2015.

This warranty is given by HHGL Limited, MK9 1BA; HHGL (ROI) Limited, D02 X576.

Please note: This warranty does not apply to products misused or neglected and only covers domestic use. It does not apply to commercial use of the product. In addition, the warranty will be void for the following reasons: Any damage resulting from product misuse or product neglect.

ENVIRONMENTAL PROTECTION



Waste electrical products must not be disposed of with household waste. Please recycle where facilities exist. Check with your local authorities or retailer for recycling advice.