

HOMEBASE

HATTIE EASY-FIT PENDANT

H42 x Dia. 50cm

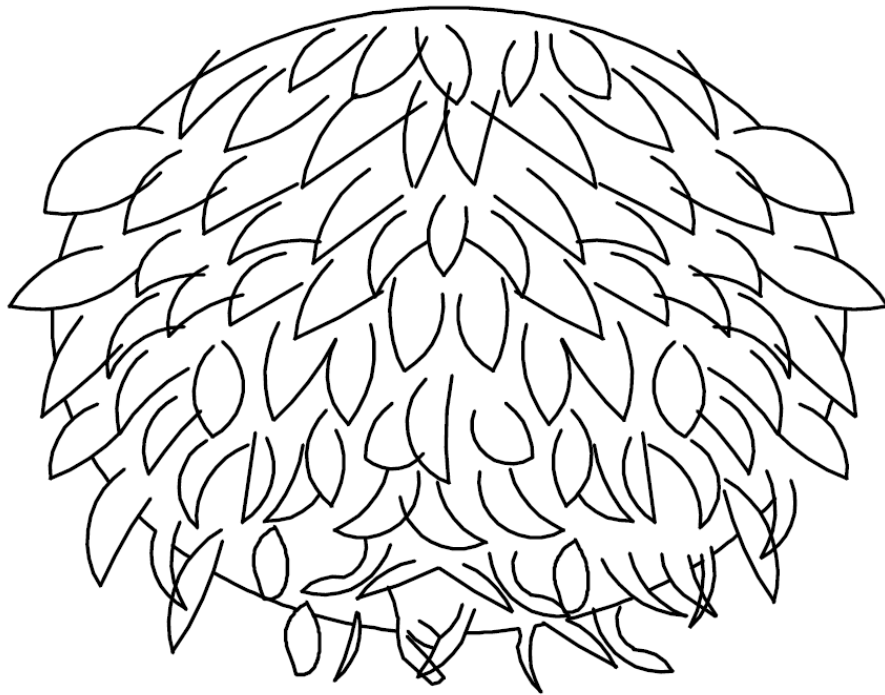

INSTRUCTION MANUAL

IMPORTANT: Please read these instructions before using the product and retain for future use.

HHGL Limited, MK9 1BA; HHGL (ROI) Limited, D02 X576

SAFETY AND CARE ADVICE

- For your safety, this product must be installed in accordance with local building regulations. If in any doubt, or where required by law, consult a competent person who is registered with an electrical self-certification scheme. Further information is available online or from your local authority.
- This product has been designed for non-professional, domestic use only.
- Dispose of all packaging correctly and responsibly and in accordance with all local laws and regulations. Never leave packaging components within reach of children, as they can be a source of danger.
- Before inserting or replacing a bulb, ensure the power is switched off and the bulb has cooled down.
- Do not modify or alter any product before or after installation. This may render the product un-safe.
- Always shut off the power to the circuit before starting installation.

WARNINGS

- This product is not intended for use by persons (including children) with reduced physical, sensory and mental capabilities, or lack of experience and knowledge, unless they have been given supervision or instruction concerning the of the product by persons responsible for their safety.
- Children should be supervised to ensure that they do not play with the product.
- Do not place this fitting in a damp atmosphere.

CARE AND MAINTENANCE

- Always disconnect the power supply when servicing or cleaning.
- Use a clean, soft, dry or slightly damp cloth for cleaning this product.
- Do not use abrasive cloths or polishes, as this may cause damage to the product.

CHANGING BULBS

- Ensure that the power supply has been disconnected.
- Ensure that the bulb has cooled down before replacing.
- We recommend LED bulbs only.
- Maximum wattage and bulb shape - see wattage label attached to the product.



Shade x 1



Metal frame x 1

ASSEMBLY

Step 1

Remove the skirt/shade ring from the lamp holder.

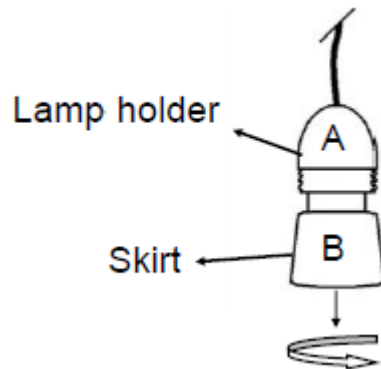

Step 2

1. Carefully pull the top and the bottom of the feather shade apart until it is fully expanded.
2. Fit the lamp holder from the ceiling pendant (not supplied) securely into the circular section of the metal frame. Re-screw the skirt/shade ring onto the lamp holder to secure the metal frame in place. Screw the bulb (not supplied) into the lamp holder, making sure you don't exceed the maximum wattage and bulb shape stated on the wattage label attached to the product.
3. Carefully slide the feather shade over the bottom of the inner metal frame until fully inside.

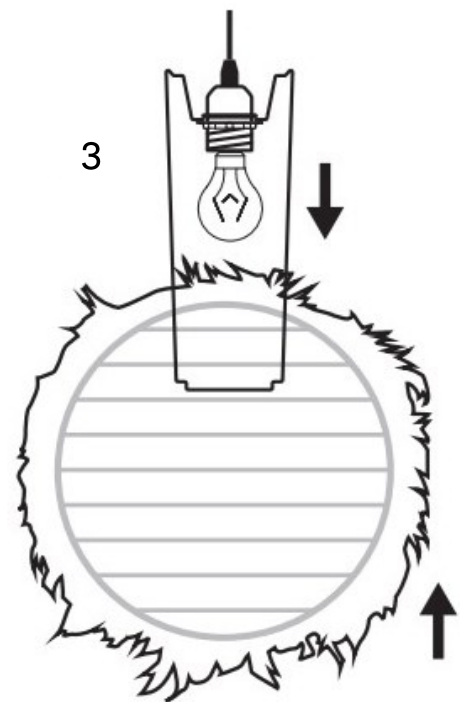
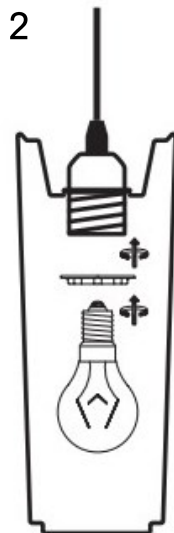
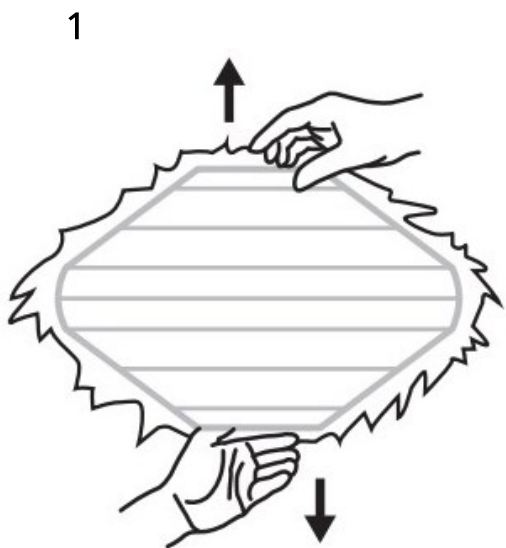

Step 3

Hook either side of the top section of the inner metal frame into the small loops in the top ring of the feather shade. Extra care should be taken to avoid damaging the feather shade. This holds the shade in shape.

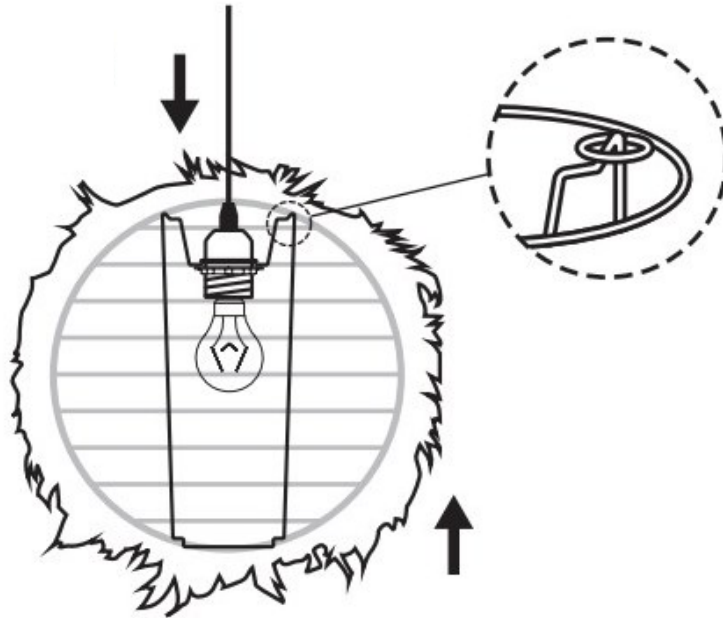

IMPORTANT NOTE

The plastic reducer ring fitted on the metal frame is required for use with normal B22/E14 lamp holders. If required, this shade can be fitted to a larger E27 lamp holder with the plastic reducer ring removed from the metal frame.

