

POWERBASE

34cm 40V Cordless
Brush Cutter 577171

Instruction Manual

IMPORTANT!
Please read these
instructions fully before
starting assembly.

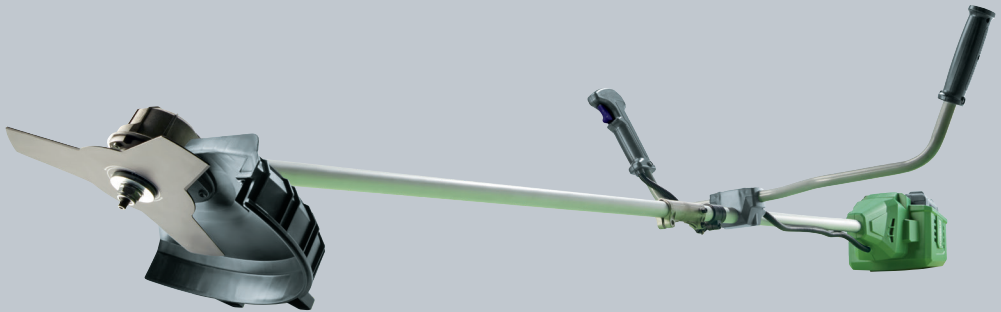

These instructions contain important information that will help you get the best from your product, ensuring it is assembled correctly and safely. If you need help or have damaged or missing parts, call the Customer Helpline on 01904 727 509.

Contents

General safety warnings	3
Intended use	12
In the box	14
Assembly	15
Operating the hedge trimmer	21
Maintenance and storage	25
Troubleshooting	29
Technical data	30
Disposal	31
Warranty	31

General Safety Warnings

Safety warnings



WARNING! Read all safety warnings and instructions. Failure to follow the warnings and instructions may result in electric shock, fire and/or serious injury.



WARNING! Read all safety warnings and instructions designated by the symbol.

Save all warnings and instructions for future reference.

- Always ensure anyone intending to operate this machine is fully conversant with the contents of this instruction manual prior to assembling, maintaining or operating the machine.
- Perform assembly operations as described in this manual. Failure to observe this warning may lead to serious injury, death, or damage to the machine.
- Always take care when removing the packaging, to prevent damage to you or to the machine.

IMPORTANT! Before assembling the machine, check all the parts indicated in the manual are in the box. Inspect all the parts for signs of damage. Do not assemble the machine if you observe any damaged components.

General safety

- **Keep this operating and maintenance manual in a safe place for reference at a later date.**
- **Read the instructions carefully.** Be familiar with the controls and the proper use of the equipment.
- **Never allow children or people unfamiliar with these instructions to use the cutter.** Local regulations can restrict the age of the operator.
- **Never mow while people, especially children or pets, are nearby.** Keep in mind that the operator or user is responsible for accidents or hazards occurring to other people or their property.
- **This machine is not intended for use by people (including children) with reduced physical, sensory or mental capabilities, or lack of experience and knowledge, unless they have been given supervision or instruction concerning the use of the machine by a person responsible for their safety.**
- **Never touch a rotating blade or trimming line.**

Personal safety

- **Use common sense when operating a power tool. Do not use a power tool while you are tired or under the influence of drugs, alcohol or medication.** A moment of inattention while operating power tools may result in serious personal injury.
- **Use Personal Protective Equipment (PPE). Always wear eye protection.** Protective equipment, such as a dust mask, non-skid safety shoes, hard hat, or hearing protection used for appropriate conditions, will reduce personal injuries.
- **Prevent unintentional starting. Ensure the switch is in the off-position before connecting to a power source and/or battery pack, picking up or carrying the tool.** Carrying power tools with your finger on the switch or energising power tools that have the switch on invites accidents.
- **Remove any adjusting key or wrench before turning the power tool on.** A wrench or a key left attached to a rotating part of the power tool may result in personal injury.
- **Do not overreach. Keep proper footing and balance at all times.** This enables better control of the power tool in unexpected situations.
- **Dress properly. Do not wear loose clothing or jewellery.** Keep your hair, clothing and gloves away from moving parts. Loose

clothes, jewellery or long hair can be caught in moving parts.

- **If devices are provided for the connection of dust extraction and collection facilities, ensure these are connected and properly used.** Use of a dust collection device can reduce dust related hazards.

Operation safety

- **Read the instructions carefully.** Be familiar with the controls and the correct use of the machine.
- **Keep in mind that the operator or user is responsible for accidents or hazards occurring to other people or their property.**
- **Wear eye protection, long trousers and stout shoes at all times while operating the machine.**
- **Avoid using the machine in bad weather conditions especially when there is a risk of lightning.**
- **Use the machine only in daylight or good artificial light.**
- **Never operate the machine with damaged guards or shields, or without guards or shields in place.**
- **Switch on the motor only when the hands and feet are away from the cutting means.**

- **Always disconnect the machine from the power supply (e.g. remove the battery pack from the machine)**
 - 1) Whenever the machine is left unattended.
 - 2) Before clearing a blockage.
 - 3) Before checking, cleaning or working on the machine.
 - 4) After striking a foreign object.
 - 5) Whenever the machine starts vibrating abnormally.
- **Take care against injury to feet and hands from the cutting means.**
- **Always ensure that the ventilation openings are kept clear of debris.**
- **Never fit metal cutting elements.**
- **Always be sure of your footing on slopes.**
- **Walk, never run.**
- **Never overreach and keep your balance at all times.**
- **Always remove the battery pack before touching hazardous parts, and ensure they have come to a complete stop.**

General safety warnings for battery chargers



WARNING! This machine is not intended for use by persons (including children) with reduced physical, sensory or mental capabilities, or lack of experience and knowledge, unless they have been given supervision or instruction concerning the use of the machine by a person responsible for their safety.

WARNING! Children should be supervised to ensure that they do not play with the machine.

- **Before charging the battery, read all the instructions carefully.**
- **After charging, disconnect the battery charger from the mains supply.** Then remove the chassis connection and then the battery connection.
- **Do not charge a leaking battery.**
- **Do not use chargers for works other than those for which they are designed and intended.**
- **Before charging, ensure your charger is matching the local AC supply.**
- **For indoor use. DO NOT expose to rain.** The charging device must be protected from moisture.

- **Do not use the charging device in the open.**
- **Do not short out the contacts of the battery or charger.**
- **Respect the polarity (+/-) when charging.**
- **Do not open the unit and keep out of the reach of children.**
- **Do not charge the batteries of other manufacturers or ill-suited models.**
- **Ensure that the connection between the battery charger and battery is correctly positioned, and is not obstructed by foreign bodies.**
- **Keep the battery chargers slots free of foreign objects and protect it from dirt and humidity.** Store in a dry and frost-free place.
- **When charging batteries, ensure that the battery charger is in a well-ventilated area and away from flammable materials.** Batteries can get hot during charging. Do not overcharge any batteries. Ensure that batteries and chargers are not left unsupervised during charging.
- **Do not attempt to recharge non-rechargeable batteries, as they can overheat and break.**
- **Longer life and better performance can be obtained if the battery pack is charged when the air temperature is between 18°C and 24°C.** Do not charge the battery pack

in air temperatures below 0°C, or above 40°C. This is important as it can prevent serious damage to the battery pack.

- **Only charge a battery pack of the same model provided by the manufacturer or different models recommended by them.**

Safety warnings for battery packs

- **Do not dismantle, open or shred cells or battery packs.**
- **Do not short-circuit a battery pack. Do not store battery packs haphazardly in a box or drawer where they may short circuit each other, or be short-circuited by conductive materials.** When the battery pack is not in use, keep it away from other metal objects, like paper clips, coins, keys, nails, screws or other small metal objects, that can make a connection from one terminal to another. Shorting the battery terminals together may cause burns or a fire.
- **Do not expose the battery pack to heat or fire.** Avoid storing in direct sunlight.
- **Do not subject the battery pack to mechanical shock.**
- **In the event of battery leakage, do not allow the liquid to come into contact with the skin or eyes. If contact has been made, wash the affected area with copious amounts of water and seek**

medical advice.

- **Seek medical advice immediately if a cell or battery pack has been swallowed.**
- **Keep the battery pack clean and dry.**
- **Wipe the battery pack terminals with a clean, dry cloth if they become dirty.**
- **The battery pack needs to be charged before use.** Always refer to this instruction manual and use the correct charging procedure.
- **Do not keep the battery pack on charge when it is not in use.**
- **After extended periods of storage, it may be necessary to charge and discharge the battery pack several times to obtain maximum performance.**
- **The battery pack gives its best performance when it is operated at normal room temperature ($20^{\circ}\text{C} \pm 5^{\circ}\text{C}$).**
- **When disposing of several battery packs, keep battery packs of different electrochemical systems separate from each other.**
- **Recharge only with the charger specified by the manufacturer. Do not use any charger other than that specifically provided for use with the equipment.**
A charger that is suitable for one type of battery pack may create a risk of fire when used with another battery pack.

- **Do not use any battery pack which is not designed for use with the equipment.**
- **Keep the battery pack out of the reach of children.**
- **Retain the original instruction manual for future reference.**
- **Remove the battery from the equipment when it is not in use.**
- **Dispose of safely in an environmentally friendly manner.** Not with domestic, household waste.

Intended Use

This Li-ion cordless brush cutter is intended for cutting bushes, weeds, grass or similar soft vegetation, in areas that are hard to reach, e.g. under bushes, on slopes and edges. It may not be used to work on unusually thick, dry or wet grass, e.g. pasture grass, or to shred leaves. For safety reasons, it is essential to read this entire instruction manual before first operation and to observe all the instructions herein. This product is intended for private domestic use only, not for any commercial trade use. It must not be used for any purposes other than described in this manual.

Warnings Symbols

The following warning symbols appear through this manual and indicate the appropriate safety measures you should take when operating and maintaining the machine.



Warning!



Read the instructions for use prior to operating the machine.



Keep bystanders away.



Wear eye and ear protection.



Wear protective gloves.



Wear safety shoes.



Beware of blade thrust!



Do not expose the machine to water or operate it in the rain.



This unit is not intended for use with a toothed saw type blade.



Guaranteed sound power level data (94dB).



Keep by-standers well away. They could be injured by flung out objects.



The product complies with the applicable European directives and an evaluation method of conformity for these directives was done.



The product complies with the applicable UK directives and an evaluation method of conformity for these directives was done.

In the Box

Parts

1. Battery packs x 2
2. Dual port charger
3. Shoulder strap
4. Adjustment knob
5. Brush cutter blade
6. Hex key & hexagon socket wrench
7. Operation handle
8. Safety guard
9. lower shaft
10. Upper shaft
11. Handle holder
12. Spool

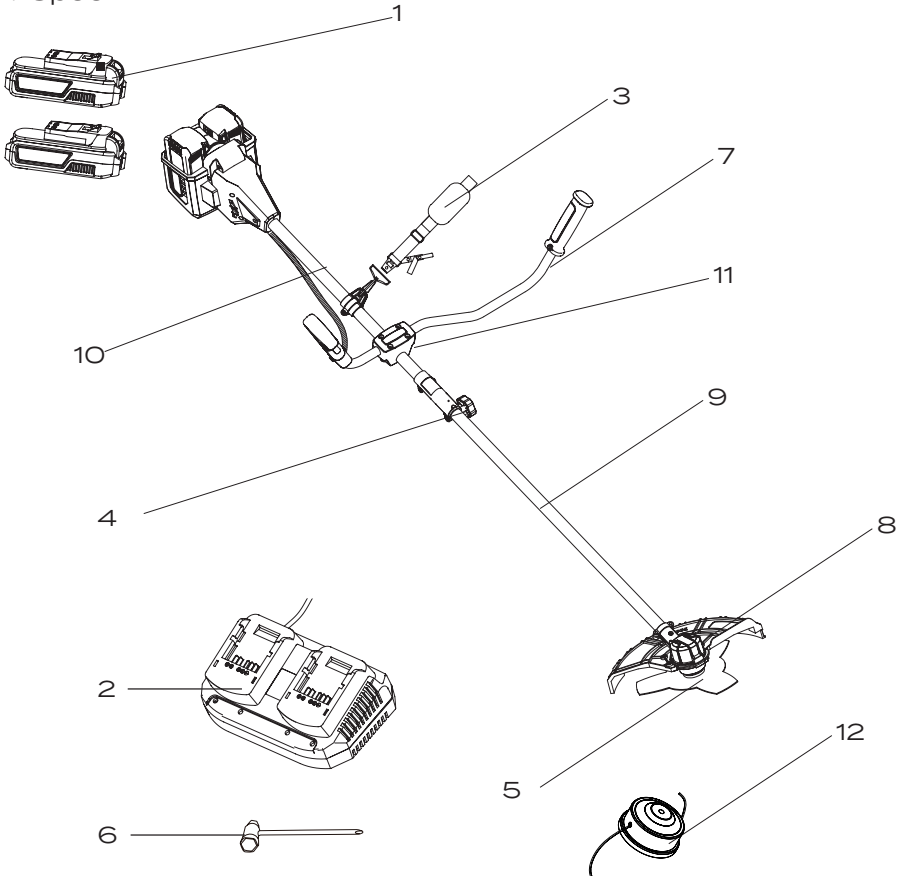

Assembly



WARNING! Always take care when removing the packaging to prevent causing damage to the machine.

1. Remove all parts of the brush cutter from the box and carefully remove all packaging. Take care not to lose any instructions which may be affixed to the parts. These provide important information which will be required when assembling the brush cutter.
2. Keep all packaging until the brush cutter is fully assembled and has been operated successfully.

NOTE: Always recycle the packaging in accordance with local recycling schemes.

Assemble the operation handle

Release the inner hex screws and remove the upper cover of the handle holder.

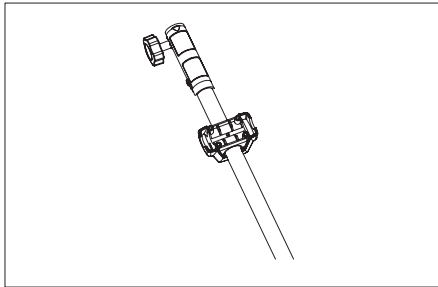

Put the handle on the handle holder (match the hole on the handle to the cylinder on the holder).

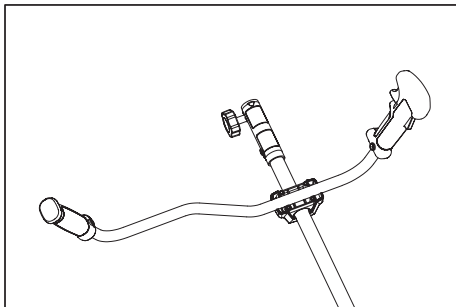

Assemble the upper cover of the handle holder.

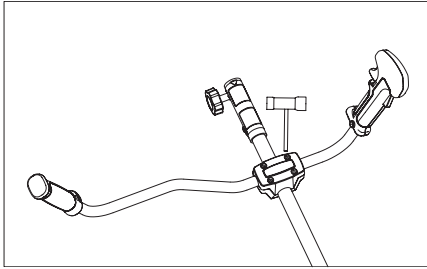

Assemble the lower shaft

Release the fasten bolt on the shaft connector. Insert the lower shaft into the connector, make sure the stop pin (a) on the shaft slots into the hole (b). Fasten the bolt on the connector.

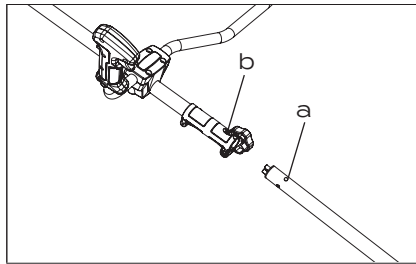

Assemble the safety guard

Put the guard onto the working head.

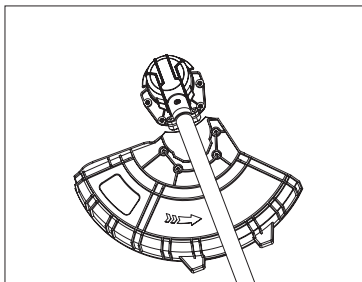

Fix the guard with 4 screws and tighten the screws.

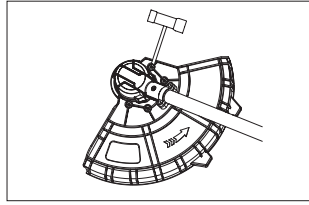

Assemble the brush cutter blade

Press the lock button (C) to fix the output shaft, then rotate the nut in clockwise direction by the socket wrench.

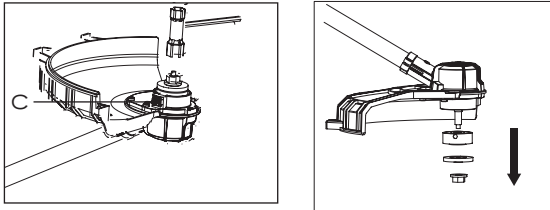

Take the outer flange off after releasing the nut, then put the blade, outer flange and nut according to priority, and fasten the nut in anti-clockwise direction.

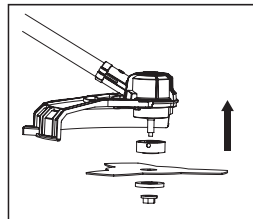

Assemble the trimmer spool

Disassemble the brush cutter blade as well as the blade retainer. Put the spool on the bolt, lock the flange and then fasten the spool by anti-clockwise.

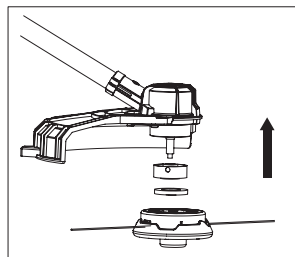

Fit the shoulder strap

Hook the shoulder strap into the supporting ring on the shaft. Adjust the length until the shaft is below your right hip.

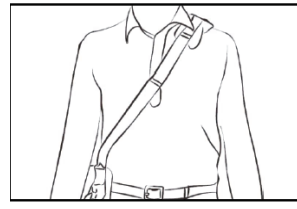
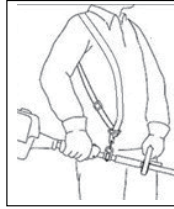
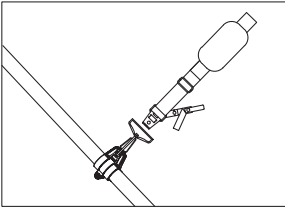

NOTE: Let the cutting attachment rest lightly on the ground. If you use a cutting blade, it should balance about 10cm above the ground to prevent contact with stones and the like. Adjust the position of the harness clamp to balance the unit correctly.

Installing or removing the battery pack

Hold the tool and the battery pack firmly when installing or removing the battery pack. Failure to hold the tool and the battery pack firmly may cause them to slip off your hands and result in damage to the tool and battery pack, potentially causing a personal injury.

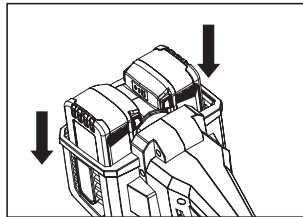

Always switch off the tool before installing or removing the battery pack. Always switch off the tool before installing or removing the battery pack.

To remove the battery pack, press the release button (a) and pull out. To install the battery pack, align the tongue on the battery pack with the groove in the housing and slip it into place. Always insert it all the way until it locks in place with a little click. If not, it may accidentally fall out of the tool, causing injury to you or someone around you.

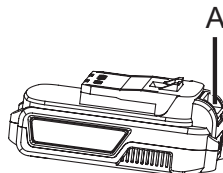

**WARNING!**

Do not use force when installing the battery pack. If the battery pack does not slide in easily, it is not being inserted correctly.



Verify that the switch is in the OFF position before inserting or removing the battery pack.



Verify that the battery pack has been removed and the switch is in the OFF position before inspecting, adjusting or performing maintenance on any part of the brush cutter.



Read, understand and follow the instructions contained in the section entitled charging procedure.

Charging the battery pack



NOTE: The battery pack comes partly charged. Charge the battery pack prior to first use, ideally at least 60 minutes.

- . Always pull out the plug of charger from the mains before removing or connecting the battery pack to the charger.
- . Never charge the battery pack when the ambient temperature is below 0 °C or above 45°C.
- . Never recharge a battery pack again immediately after rapid charging. This could overcharge the battery pack, thus reducing the lifespan of the battery pack and charger.
- . Rest the charger for at least 15 minutes between continuously charging sessions.
- . If no battery pack is inserted into the charger and the charger is connected to mains, the charging status LED shows red.



NOTE: Always fully charge the two batteries at same time.

Checking battery capacity

Press the battery capacity level button to check the charging level of the battery pack. The status/remaining charge will be shown on the battery charging level indication light.

3 Green LEDs continuously lit	Battery pack fully charged
2 Green LEDs continuously lit	Battery pack 65% charged
1 Green LED continuously lit	Battery pack 35% charged
No LED lit	Battery is dead and needs to be charged

Charge the battery pack before operating when it is at medium or low battery charging level.

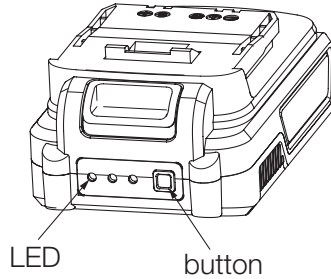

- i. Connect the battery pack to the battery charger.
- ii. Insert the mains plug into the socket. The green charging status LED light will flash. Once the battery pack is completely charged, the green charging status LED is lit continuously, indicating that the charging process is complete.
- iii. Disconnect the charger from the mains and remove the battery pack from the charger.
- iv. Attach the battery pack back to the product.

Charging status LEDs

Red LED turns on	Charger ready
Green LED flashes	Battery pack charging
Green LED continuously lit	Battery pack fully charged
Red and green LEDs flashing	Battery pack defect
Red and green LEDs continuously lit	Battery pack too cold or warm

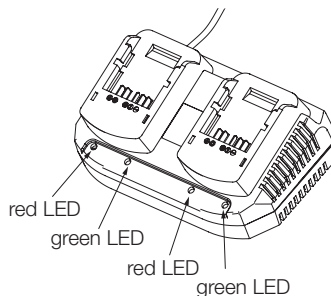

Operation

Starting



WARNING! Do not start the unit until it has been completely assembled. Danger of injury!



WARNING! Do not operate the device unless you did not find any faults. If a part has become defective, make sure to replace it before you use the device again.

Installing the battery pack

Keep the battery pack in line with the holder on the device. Push it forward until it reaches the bottom. Before starting, make sure the battery pack is firmly locked in place.

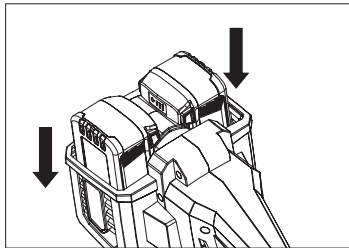

Switch on/off

Press and hold the safety lock-off button (a) and then press the trigger (b) on the handle.

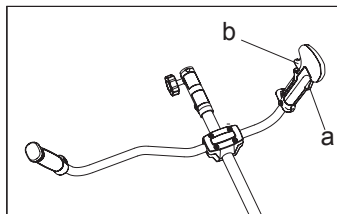

Adjusting line length while working

This machine is fitted with a 'Tap & Go' head. To release more line, tap the cutting line head against the ground with the motor at top speed; the line will be released automatically and the knife will cut off the excess length.

Working instructions

Extending the cutting line



WARNING! Do not use any kind of metal wire or metal wire encased in plastic in the line spool. This may cause serious injuries to the user. To extend the cutting line, run the engine at full speed and tap the line spool on the ground. This will automatically extend the line.

The blade on the safety shield will cut the line to the appropriate length.

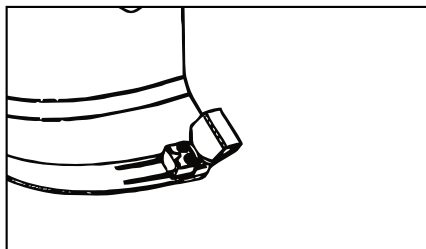

IMPORTANT: Remove all grass and weed remnants at regular intervals to prevent the shaft tube overheating. Lawn, grass and weed remnants become trapped under the safety shield and prevent the shaft tube from receiving adequate ventilation. Remove the remnants carefully using a tool. Do not use bare hands.

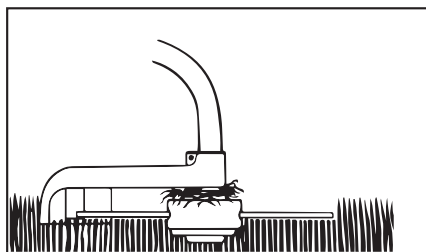

Different cutting methods

When the equipment is correctly assembled it will cut weeds and long grass in places which are difficult to access, e.g. along fences, walls and foundations, and trees. It can also be used for 'mowing' down vegetation to prepare a garden for other applications.

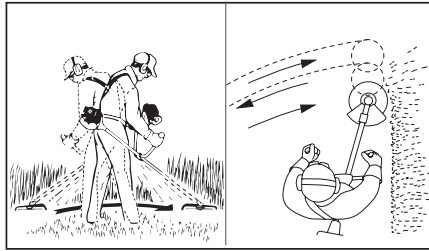

ATTENTION: Even if it is used carefully, cutting around foundations, stone or concrete walls will result in the line suffering more than normal wear.

Trimming/mowing

Swing the trimmer from side to side in a scything motion. Always keep the line spool parallel to the ground. Check the site and decide which cutting height you require. Guide and hold the line spool at the required height to obtain an even cut.

Low trimming

Hold the trimmer right in front of you at a slight angle so that the underside of the line spool is above the ground and the line strikes the correct target. Always cut away from yourself. Never draw the trimmer towards yourself.

Cutting along fences/foundations

Approach wire mesh fences, lath fences, natural stone walls and foundations slowly so that you can cut close to them without striking the obstacle with the line. If, for example, the line strikes stones, stone walls or foundations, it will wear or fray. If the line strikes wire fencing, it will break.

Trimming around trees

When trimming around tree trunks, approach slowly so that the line does not strike the bark. Walk around the tree, cutting from left to right. Approach grass or weeds with the tip of the line and tilt the line spool forwards slightly.



WARNING! Take extreme care during mowing work. When doing such work, keep a distance of 30 metres between yourself and other people or animals.

Mowing

When mowing, you want to cut all the vegetation down to the ground. To do this, set the line spool at an angle of 30° to the

right. Place the handle in the required position. Remember the increased risk of injury to the user, bystanders and animals, and the danger of damaging property due to objects (for example stones) being thrown.



WARNING! Do not use the equipment to remove objects from footpaths, etc. The equipment is a powerful tool and can throw small stones and other objects a distance of 15 metres or more, causing injuries and damage to cars, houses and windows.

Jamming

If the cutting blade jams as a result of attempting to cut vegetation that is too dense, switch off the engine immediately. Remove the grass and scrub from the equipment before you restart it.

Preventing recoil

When you work with the blade, there is a risk of recoil if it strikes solid objects, such as tree trunks, branches, tree stumps or stones. This will throw the equipment backwards in the direction opposite to the rotation of the tool. This can cause you to lose control of the equipment. Do not use the blade near fences, metal posts, boundary stones or foundations.

Maintenance and Storage



Injury warning: Always wear protective gloves when working on or around cutting tools.

When not in use, in transit or storage, always install transport protection on all cutting tools. Before performing any maintenance or cleaning work, always turn off the engine and pull out the spark plug boot.

Do not spray the unit with water. It damages the engine. Clean the unit with a cloth or hand brush, etc.

Expert examination required:

- When the brush cutter hits an object.
- When the engine suddenly stops.
- If the blade is bent (do not straighten yourself!)
- If the gearbox is damaged.

Regular checks

Keep in mind that the following specifications relate to normal usage. Owing to circumstances (longer periods of daily work, severe dust exposure, etc.), the specified intervals will become correspondingly shorter.

Before the start of work and after refuelling

Check if cutting tools are positioned securely, examine the product for any signs of damage or deterioration, and sharpen the cutting blade.

If necessary

Retighten accessible fastening screws and nuts. You will avoid excessive wear and tear and damage of the tool when you follow the instructions in this manual.

Replacing the spool line

1. Dismantle the line spool as described in the 'Assembly' section. Press the spool together and remove one half of the housing.

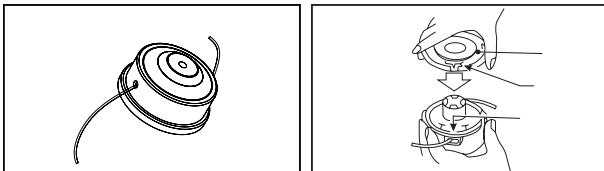

2. Take the spool plate out of the line spool housing.

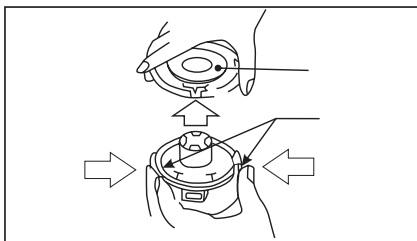

3. Remove any remaining cutting line.
4. Place the new cutting line in the centre and hang the loop which has formed into the recess in the spool splitter.

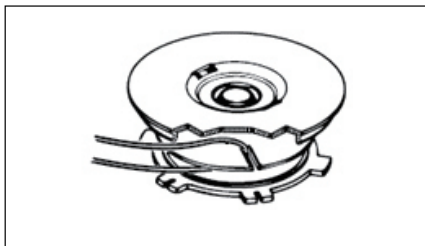

5. Under tension, wind the line onto the spool anti-clockwise. The spool splitter will separate the two halves of the line.

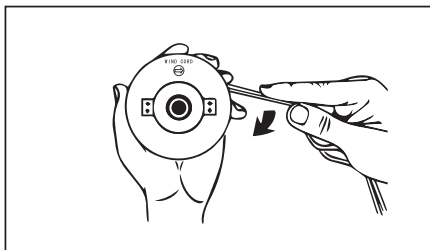

6. Hook the last 15cm of the two ends of the line onto the opposite lying line holders of the spool plate.

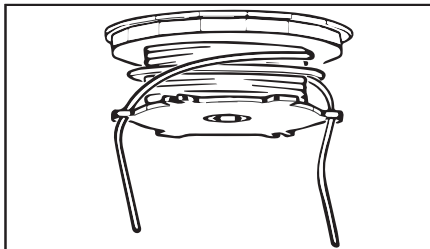

7. Thread the two ends of the line through the metal eyelets in the line spool housing.
8. Press the spool plate into the line spool housing.
9. Pull the two line ends sharply to release them from the line holders.

10. Join the housing parts together again.
11. Cut the excess line to a length of around 13cm. This will reduce the load on the engine when starting and warming up.
12. Remount the line spool. If you are replacing the complete line spool, skip 'Assembly'.

Grinding the safety hood blade

The safety hood blade can become blunt over time. When you notice this, undo the screw holding the safety hood blade on the safety hood.

Clamp the blade in a vice.

Sharpen the blade with a flat file and make sure that the angle of the cutting edge is not altered in the process. File in one direction only.

The safety hood blade will become blunt over time we therefore recommend replacing the blade with a new one or re-sharpen it at the end of every season.

To re-sharpen the blade, clamp the safety hood blade securely in a vice or clamp and undo the screw which holds the blade. A flat file should be used when re-sharpening the blade with a flat file ensuring not to alter the angle and file in one direction only.

An unbalanced blade will cause the brush cutter to vibrate violently and may result in injury to the operator.

Storing the unit

After cutting, clean the unit thoroughly. Store the unit in a dry room, allowing the motor to cool down beforehand.

Transport:

Due to security reasons, please see to it that the equipment is transported free of oil and gas!

Worn parts

Even when used in the intended way, some components are subject to normal wear. They will have to be replaced depending on the duration of usage. These parts include, among others, the cutting tool and the retaining disk.



WARNING! Use only the original manufacturer's replacement parts, accessories and attachments. Failure to do so can cause poor performance, possible injury and may invalidate your warranty.

Replacement parts/accessories:

For the cutting attachment listed here, you can always use the safety guards provided with the unit.

Machine/brush cutter:

3541000101047001	Shoulder strap
3222470101132001	Cutting blade
3122470201127001	Spool line

Cleaning and storage

After use, remove the battery pack from the trimmer.

When not in use, store the machine in a dry, safe place, out of the reach of children.

Use only manufacturer recommended replacement parts and accessories.

To clean the tool, remove the battery pack and use a mild soap solution and a damp cloth to clean it. Do not immerse the tool in water or squirt it with a hose. Do not allow any liquid to get inside it. Do not clean with a pressure washer.

Troubleshooting

Although your new cordless grass trimmer is really easy to operate, if you do experience problems, check the following:

Tool runs slowly

Check that the spool housing can rotate freely. Carefully clean it if necessary.

Check that the cutting line does not protrude more than 9cm from the spool housing. If it does, cut it off so that it just reaches the line trimming blade.

If the trimmer is not cutting properly

Check the condition of the cutting head if the cutting line is too short or the cutting head is damaged.

Note: Do not use a damaged cutting head.

If the trimmer will not operate

Check the battery pack assembly.

Charge the battery: operation of the grass trimmer is dependent upon sufficient charge in the battery pack.

If the battery will not charge

Check to see if the battery is properly inserted into the charger base, and make sure the indicator light is on. If not, check the power supply to the socket used for the charger plug.

If a fault is suspected, return the trimmer to an authorised dealer for repair.

Technical Data

Property	Value
Model No.	GY2247
Voltage	40V  (2X20V)
No load speed	5800min ⁻¹
Brush cutter	
Sound pressure level	LpA=79.1dB(A), K=3dB(A)
Sound power level	LwA=88.4dB(A), K=2.31dB(A)
Cutting width	255mm
Grass trimmer	
Sound pressure level	LpA=83dB(A), K=3dB(A)
Sound power level	LwA=92.5dB(A), K=1.92dB(A)
Cutting width	340mm
Vibration	1.35m/s ² , k=1.5 m/s ²
Charger	
Model No.	BOQ-SP07-2040ZB
Input voltage & power	220-240V AC, 50/60Hz 120W
Output voltage & current	21V, 4A
Battery pack	
Model No.	BOP-SP07-20-ZJ
Voltage	20V Li-ion
Capacity	2.5Ah



WARNING! The sound values have been determined according to the noise test code given in EN 786, appendices D and E. The sound intensity level for the operator may exceed 80dB(A) and ear protection measures are necessary. The declared vibration value (according to EN 60745-1) has been measured in accordance with a standard test method, and may be used for comparing one product with another. The declared vibration value may also be used in a preliminary assessment of exposure.



WARNING! This tool may cause Hand-Arm Vibration Syndrome (HAVS) if its use is not adequately managed. Preventative measures include, among others, regular maintenance and care of the product and cutting attachments, keeping hands warm and periodical breaks, as well as proper planning of work processes.

Disposal

The brusher cutter and its accessories are made of various recyclable materials. Dispose of the lawn mower in accordance with your local recycling regulations.

Getting Help

Our dedicated UK-based customer helpline is open 7 days a week to assist you with assembly, parts queries and technical support. We are open during office hours but you can always send an email via **support@coreservice.co.uk**. Our experts are here to get you back enjoying your garden in no time.

For useful assembly, starting and maintenance videos, and for ordering spares, please visit **www.coreservice.co.uk**.

Using our service does not affect your statutory rights.

Warranty

This product is covered by a 3 year warranty.

The warranty covers any manufacturing defect in materials, workmanship and finish. Any claim under this warranty must be made by going to your nearest Homebase store, taking your proof of purchase with you, and claims must be made within 3 years of the date of purchase. We will offer you a free repair of the item where this is possible, or a replacement or a refund. Your statutory rights remain unaffected, in particular any rights you may have under the Consumer Rights Act 2015.

This warranty is given by HHGL Limited, MK9 1BA; HHGL (ROI) Limited, DO2 X576.

Please note: This warranty does not apply to products misused or neglected and only covers domestic use. It does not apply to commercial use of the product. The warranty period for the battery pack and charger is 1 year.