

SOVEREIGN

EASY GARDENING

29CM 1100W ELECTRIC HOVER MOWER

Item No. 577134

Model No. MEH1129B



INSTRUCTION MANUAL

Please read these instructions fully before starting assembly.

HHGL Limited, MK9 1BA; HHGL (ROI) Limited, D02 X576

Aug 20

CONTENTS

General safety warnings	3
In the box	11
Assembly	12
Operating instructions and tips	14
Maintenance	22
Plug replacement	24
Troubleshooting	25
Technical data	26
Recycling and disposal	26
Getting help	26
Warranty	27

GENERAL SAFETY WARNINGS

Safety information

WARNING! Read all safety warnings and instructions.

Failure to follow the warnings and instructions may result in fire and/or serious injury.

Warnings Symbols

The following warning symbols appear throughout this manual and indicate the appropriate safety measures you should take when assembling and operating the mower.

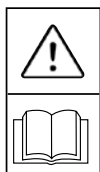

Read operator's manual before use.



Wear eye and hearing protection (PPE).



Do not expose to rain.



Keep bystanders away.



Remove plug from mains before maintenance or if cord is damaged.



Keep flexible supply cord away from cutting means.



Guaranteed sound power level data (96dB) in accordance with Directive 2000/14/EC.



Class II equipment.



Do not dispose of electrical equipment with household waste.



This device complies with the applicable European directives, and an evaluation method of conformity for these directives has been done.



The product complies with the applicable UK directives and an evaluation method of conformity for these directives was followed.



Cutting width.



IMPORTANT! When using the mower, the following safety precautions must be followed to avoid injuries and damage.

- Read all operating instructions carefully and comply with them. It is important to understand these instructions and to acquaint yourself with the mower, its correct usage and all safety requirements.
- Keep this manual in a safe place so that the information is available at all times.
- If you give the equipment to any other person, give them these operating instructions as well.

General Safety

We accept no liability for damage or accidents which result from non-compliance with these instructions.

Intended Use

This hover mower has been designed for cutting grass and soft vegetation in private and hobby garden areas. It should only be used for its prescribed purpose, and any other use is deemed to be a case of misuse.

PLEASE NOTE: Our equipment has not been designed for use in commercial, trade or industrial applications. Our warranty will be void if the mower is used in commercial, trade or industrial applications or for an equivalent purpose.

Power Supply

Before you connect the equipment to the mains supply, ensure that the data on the rating plate corresponds to your mains supply.

Personal Safety

Note! Only supply power to the mower through a circuit protected by an RCD with a maximum trip current of 30mA.

- Only use plugs or connectors approved for outdoor usage.
- Extension cables must comply to H07RN-F requirements as described in DIN 57 282/VDE 0282 and must have a minimum cross-section of 1.5mm². The plug must have an earth and any connection must also be earthed and splashproof. Before use, check the cables for signs of damage and wear. Never use the mower if the cables are not in perfect condition (this also applies to the supply cable on the mower). If the cable is damaged whilst the mower is working, disconnect the mains plug from the power supply immediately and then check the extent of the damage.
- Never allow children or others who are not familiar with the operating instructions to use the hover mower. Local regulations may stipulate the minimum age of the user of this type of appliance.
- In areas where the mains supply is weak or bearing a high load, this mower may cause further voltage fluctuations as it starts. In extreme cases, this can cause damage to other equipment working from the same supply. In this case, we recommend you temporarily switch off any unneeded equipment or connect it to a different circuit.
- This mower is not designed to be used by people (including children) with limited physical, sensory or mental capacities or those with no experience and/or knowledge, unless they are supervised by a person who is responsible for their safety or they have received instructions from such a person in how to use the mower safely. Children must always be supervised in order to ensure that they do not play with the mower.

- Always check the mower for signs of damage before each usage.
- Always disconnect the mains lead from the electrical supply before carrying out any inspection, servicing or maintenance work.
- Ensure that all the guards are securely fitted and in good working order.
- Before each use, inspect the mower to check the plastic cutters, fastening bolts and the entire cutting unit for any signs of wear or damage. To prevent imbalance or vibration, worn or damaged cutting blades and fastening bolts must always be fully replaced.
- Damaged parts on the mower must be replaced by qualified personnel. Use only genuine spare parts.
- Repair work on the electrical parts of the mower may only be carried out by a qualified electrician.
- Follow the instructions to fit or remove the plastic cutters and wear protective gloves.
- The user remains responsible for any injury to third parties within the working area of the hover mower, whilst the hover mower is being used.
- Only work in good daylight or appropriate and adequate artificial light.
- Never use the mower when you are tired.
- Never run the mower in enclosed or poorly ventilated rooms or if there are flammable or explosive fluids, vapours or gases nearby.
- If the mower has struck a foreign body, switch off the motor and disconnect the mains lead before inspection, and before cleaning the cutting head or fan.

- Check the site on which you intend to use the hover mower and remove all objects that may be caught or thrown up by the mower. Foreign bodies must be removed before you start mowing. Keep an eye on the power cable and keep it away from the cutting blade at all times.
- Ensure that you do not push the mower over areas that might damage or snare the power cable.
- Before you lift the hover mower to transport it, switch off the motor, disconnect the mains lead and wait until the cutting head has come to a complete standstill. Ensure the cutting head is facing away from you.
- Never reach towards rotating parts with your hands or feet.
- The safety distance from the moving blade produced by the push handle must be maintained at all times.
- If you use the mower on a small incline, mow across the slope (not in an up and down direction). Always be sure of your footing on slopes.
- Be particularly careful when changing direction with the mower whilst working on a slope.
- Do not use the lawn mower on gradients of over 15 degrees.
- Ensure that you have safe footing at all times whilst working with the mower.
- Always wear strong, anti-slip footwear and long trousers when using the mower. Never mow in bare feet or in open-toed sandals.
- When the mower is running, ensure that no person or animal, particularly children and pets, are in the immediate vicinity of the hover mower. Ensure that you keep everybody at least 10 metres away from the mower when it is working.
- Switch off the motor and disconnect the plug from the power supply if the mower strikes a foreign body. Check the mower for signs of damage and carry out all necessary repair work, before you start the mower again.

- If the hover mower begins to vibrate abnormally, switch it off immediately, disconnect the plug and check it carefully. Ensure that all the nuts, bolts and screws are tight and that the mower is in a safe condition for use.
- Do not leave the mower out in the rain. The lawn must not be wet or very damp.
- Only push the mower at a normal walking pace.
- Be particularly careful when you change the direction of the mower or pull it towards you. Avoid pulling it towards you while the blade is moving.
- Never run or attempt to push the mower over any areas except your lawn or other grassed areas. Carefully actuate the starter switch in accordance with the instructions (see 'Operating instructions' section).
- Do not switch the mower on and off frequently over a short period of time, and in particular, do not play with the ON/OFF switch.
- Do not touch the cutting head until the machine has been disconnected from the mains and the cutting blade has reached a complete standstill.
- Never lift or carry the mower whilst the motor is running.
- Switch off the motor and disconnect the plug whenever you leave the hover mower.
- Keep the hover mower in a dry place which is inaccessible to children at all times.
- Before you adjust or clean the mower or check whether the mains lead is kinked or damaged, switch off the mower and disconnect the plug from the power supply.

Operating and maintenance safety



CAUTION! Read all safety requirements and instructions. Any errors made in following the safety requirements and instructions may result in an electric shock, fire and serious injury.

Keep all safety regulations and instructions in a safe place for future use.

- Do not use the hover mower if the cords are damaged or worn.
- Do not connect a damaged cord to the mains supply or touch a damaged cord before it is disconnected from the mains supply. A damaged cord could allow parts to become live and cause a risk of electrocution.
- Do not attempt to touch the blades before the mower is disconnected from the supply and the blades have come to a complete stop.
- Keep extension cables away from the blade. The blade can cause damage to cords and lead to contact with live parts.

Disconnect from the mains supply (i.e. remove the plug from the mains socket) in the following situations:

- whenever leaving the mower unattended
- before cleaning a blockage
- after striking a foreign object
- whenever the mower starts vibrating abnormally.

IN THE BOX

Parts

- | | | |
|------------------------------|----------------------------|------------------------|
| ❶ Switch box | ❺ Lower handle | ❾ Cable clamp |
| ❷ Start/stop switch lever | ❻ Grassbox | ❿ Grassbox lid |
| ❸ Upper handle | ❼ Safety lock-off button | ⓫ Retaining pin button |
| ❹ Handle fastening wing nuts | ❽ Cable strain relief hook | ⓬ Bolts |

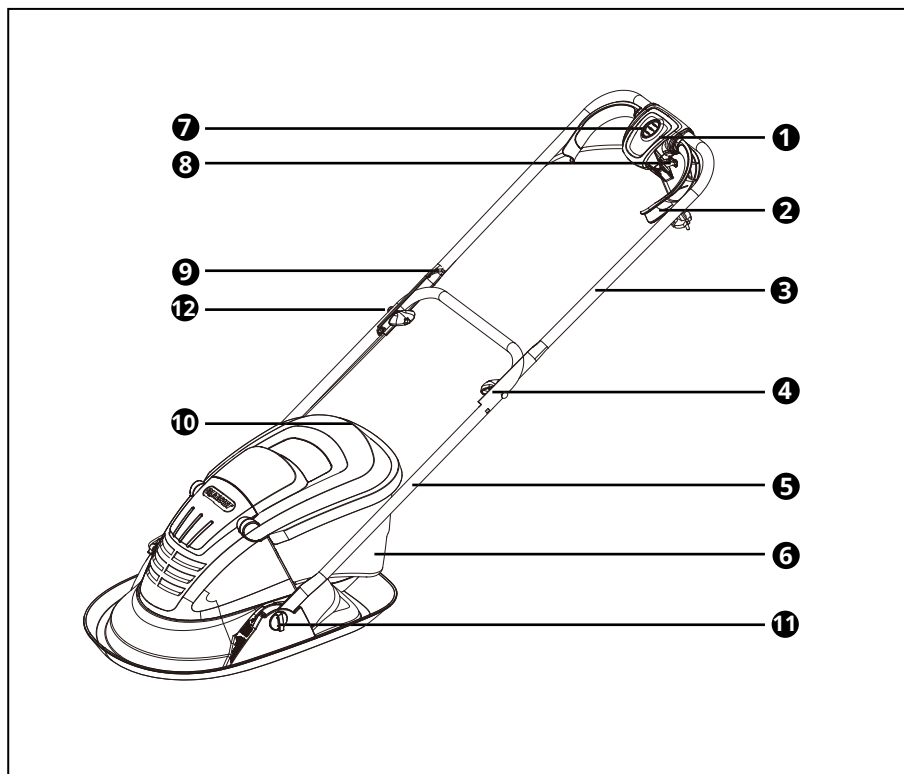

ASSEMBLY

Handle Assembly

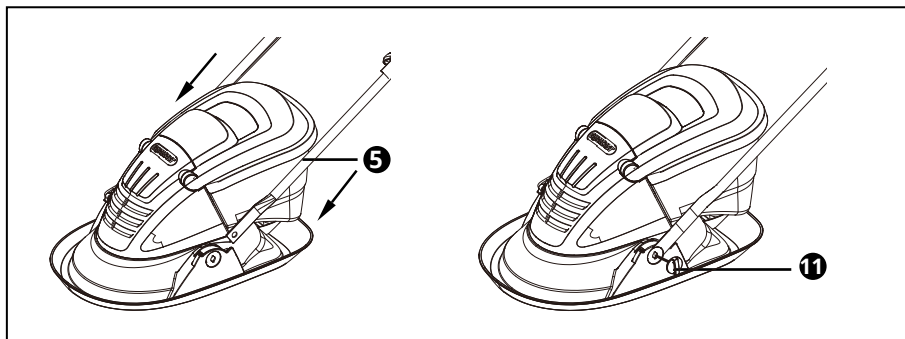

1. Place the ends of the lower handle **5** into the slots.
2. Secure the lower handle **5** to the deck by firmly pushing a retaining pin **11** through the retaining holes on the deck and through the bottom end of the handle.
3. Repeat on the other side.

The push handles must be fully assembled, undamaged and in correct working order before using the hover mower.

Follow the operating instructions step-by-step and use the pictures provided as a visual guide to assemble these parts.

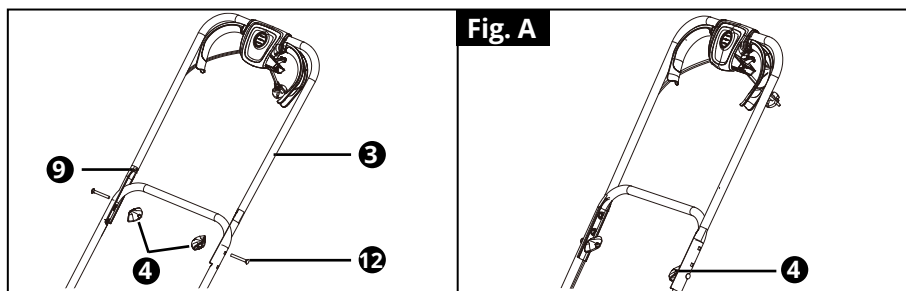

4. Ensure the upper handle **3** and the lower handle **5** are aligned correctly and move freely.
5. Fix the upper handle **3** section to the lower handle **5**. Use the bolts **12** and wing nuts **4** provided. There are two possible height positions. Choose the one most suitable to the operator's height.
6. Clip the cable to the handle bar with the cable clamp **9**.

When the two wing nuts are loosened, the handle can be folded (Fig. A) for easy storage. Ensure the power cable (Fig. A) is not caught between the folding sections.

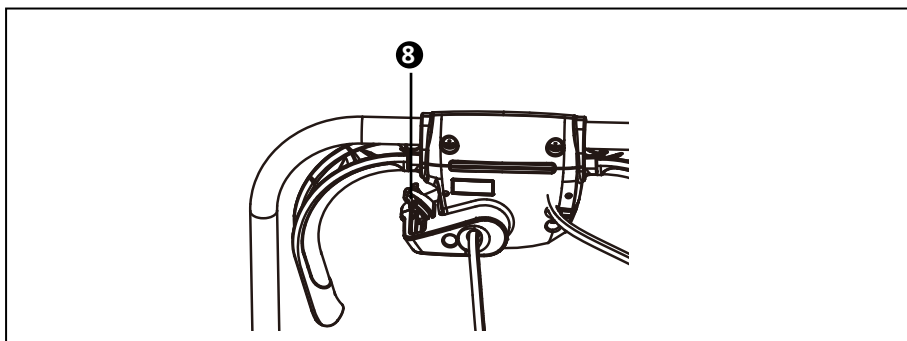

7. Hook the cable (or extension cable if you are using one) through the extension cable strain relief hook **8**, as shown above, to help prevent it from coming loose or disconnected whilst you are mowing.

OPERATING INSTRUCTIONS AND TIPS

Setting the cutting heights

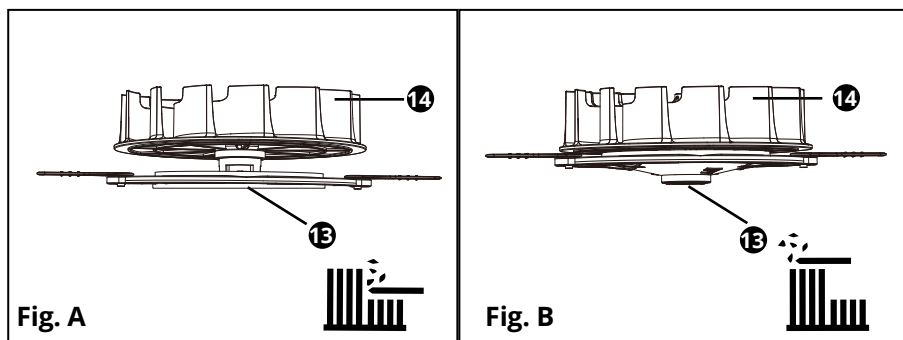

! IMPORTANT! Ensure the power cable plug is removed from the mains supply and wait until the cutting head has stopped rotating, before adjusting the cutting height.

1. There are 2 cutting heights: Fig. A shows the lower cutting height setting, 10mm. Fig. B shows the Higher cutting height setting, 33mm. The blade is pre-set to the 33mm cutting height in the factory.
2. Adjust the cutting height by turning over the cutting head **13**.
3. Disconnect from the main power supply and wait until the fan **14** and the cutting head **13** have stopped rotating.
4. Turn your product upside down.

! A higher cut cutting height (see Fig. B) should generally be selected for the first cut of the season. When cutting longer grass, cut the grass in 2 or more stages; first on the higher cutting setting, then on the lower cutting setting. These techniques will help to avoid over-stressing your grass.

Removing the cutting head and fan

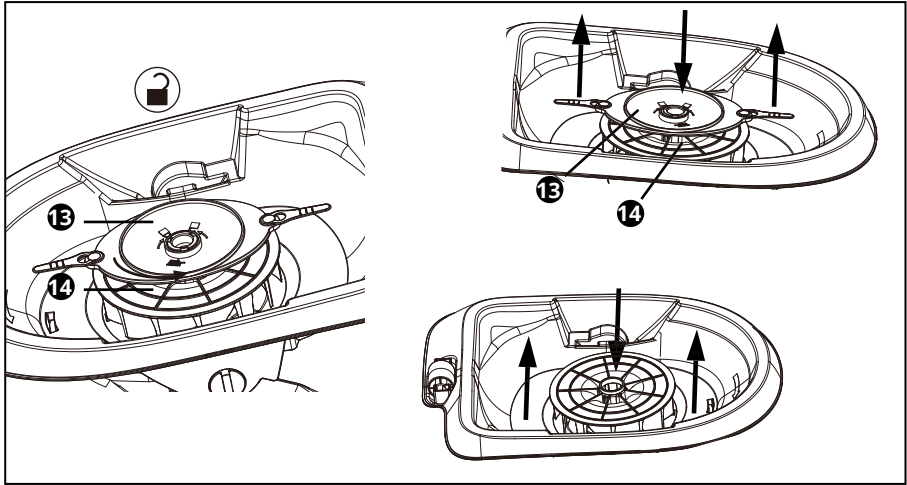

1. Hold the fan **14** firmly and twist the cutting head **13** anticlockwise, as illustrated above.
2. Hold the cutting head **13** in the centre and remove, as illustrated above.
3. Hold fan **14** in the centre and remove, as illustrated above.
4. Inspect for damage and clean as necessary, before replacing the fan and cutting head.

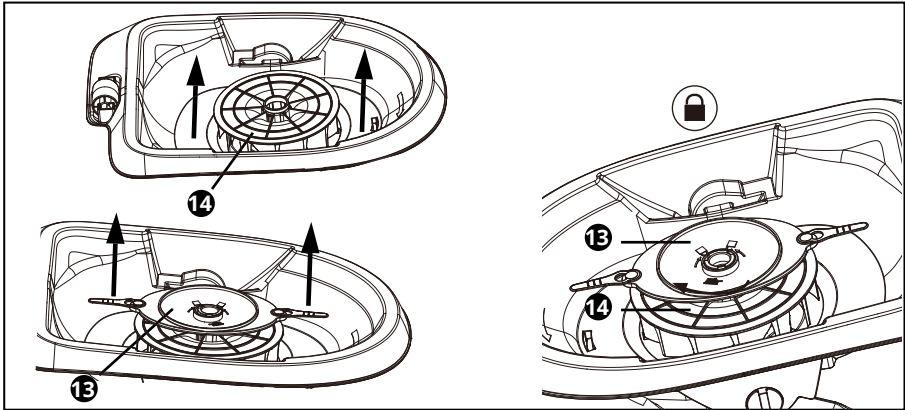

Refitting the fan and setting the cutting height

1. Replace the fan **14** on the motor drive shaft, as illustrated above.
2. Position the cutting head **13** onto the motor drive shaft, according to the height of the cut you require. Position the blades flush with the fan, if you want the higher setting (33mm).
3. If you want the lower cutting height setting (10mm), turn the cutter head **13** the other way round, with a larger space between the fan **14** and the cutting blades.
4. Hold the fan **14** firmly and twist the cutting head **13** clockwise, as illustrated above. Ensure it is securely locked into position.

! **IMPORTANT!** Always ensure the fan and cutting head are correctly located on the drive shaft and securely locked into position. If the blade has broken, please wear gloves or necessary protective equipment (PPE) before inspecting the blade.

ON/OFF operation

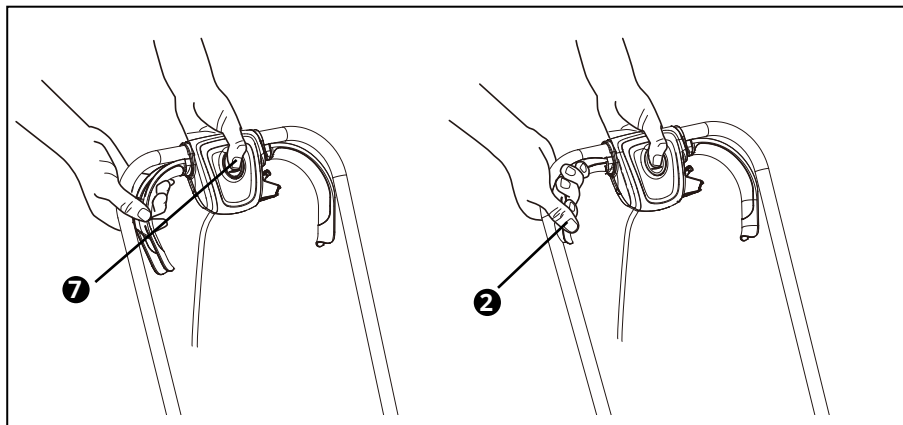

1. Connect the mower to the mains supply. Ensure the cable (or extension cable if you are using one) is hooked through the cable strain relief hook, as illustrated on page 14.
2. Before switching on, ensure that the mower is not in contact with any foreign objects.
3. To switch on, press the safety lock-off button **7** on the handle, then activate the start/stop switch lever **2**. Release the lock-off button **7**.
4. To switch off, release the start/stop switch lever **2**.
5. Start cutting once the mower has reached full speed.



NOTE: There are two start/stop switch levers fitted, either one can be used for starting the product.

After switching off the equipment, the blade may continue to turn for several seconds. Do not touch the moving blade. There is a risk of serious injury.

Operation

Before you connect the equipment to the mains supply make sure that the data on the rating plate corresponds to your mains supply.



IMPORTANT! Always ensure the on/off switch is working correctly. Do not use if you suspect a fault. Before you perform any repair or maintenance work on the mower, ensure that the plastic cutter is not rotating and that the power supply is disconnected.



IMPORTANT! Never empty the grass box if the motor is still running. The rotating plastic cutter can cause serious injuries and throw objects out at high speed.

Always ensure the grass box fits securely. Always switch off the motor before you remove it.

A safe distance between the blade deck and the user is provided by the length of the handle. This distance must be maintained at all times. Take special care when mowing and changing direction on embankments and slopes. Ensure that you have a secure surface to stand on, wear shoes with anti-slip soles that offer good grip, and long trousers. Always mow across the slope (not in up or down direction).

For safety reasons, do not use the mower on gradients exceeding 15°.

Take special care when moving backwards and pulling the hover mower. Never pull the mower backwards when the motor is running.

Emptying the grassbox

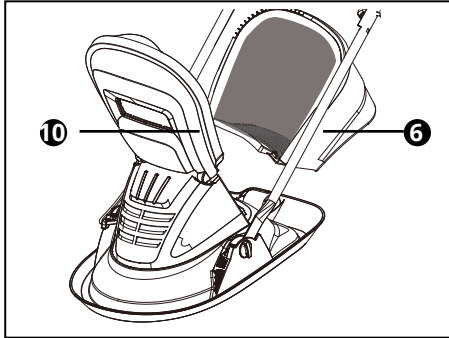

- Stop the mower, remove the plug from the mains power supply and wait until the cutting head has come to a complete stop.
- Lift up the grassbox lid ⑩.
- Lift the grassbox ⑥ off the mower and empty.
- Replace the grass box ⑥ securely and ensure the retaining hooks are correctly located in the recesses on the mower. Lower the lid ⑩ back onto the grass box ⑥.

Failure to fit the grassbox and lid correctly will cause poor collection of grass clippings.

Mowing advice

Keep the underside of the mower casing clean and remove all grass deposits from it. Deposits make it more difficult to start the mower and also adversely affect the mowing quality and the grass collection.

The cutting system must be kept in good condition and inspected before and after use. Switch off the motor before you carry out any inspections of the cutting system. Remember that the cutting head will continue to turn for a few seconds after the motor has been switched off. Never attempt to stop the cutting head.

Check plastic cutters for wear and replace when necessary. Plastic cutters should be straight, replace if bent or twisted.

Place the mains lead in loops on the ground near the wall socket. Mow away from the socket and cable and ensure that the mains lead is always on the section of lawn that you have already mowed, so that you do not run over the mains lead with the mower.

If you see the grassbox is full whilst you are mowing, you should stop the mower and empty the grassbox.

Cleaning

WARNING: Always disconnect the plug from the mains power supply and let the mower cool down before carrying out an inspection, maintenance or cleaning.

- Remove grass from under the deck with a piece of wood or similar.
- Using a soft brush, remove grass clippings from all ventilation openings, the roller, grassbox and grassbox lid.
- Remove the cutting head, to gain access to the fan, and clean with a soft brush.
- Wipe over the surface of your product with a dry cloth.

IMPORTANT! Always wear work gloves when engaging in any maintenance work.

Never use water to clean your product. Do not clean with chemicals, including petrol or solvents, as some can destroy critical plastic parts.

Maintenance

Blade maintenance

Always wear gloves when handling plastic blades and proceed with caution; sharp edges could cause injury.

Carry out the following steps to change the plastic blades:

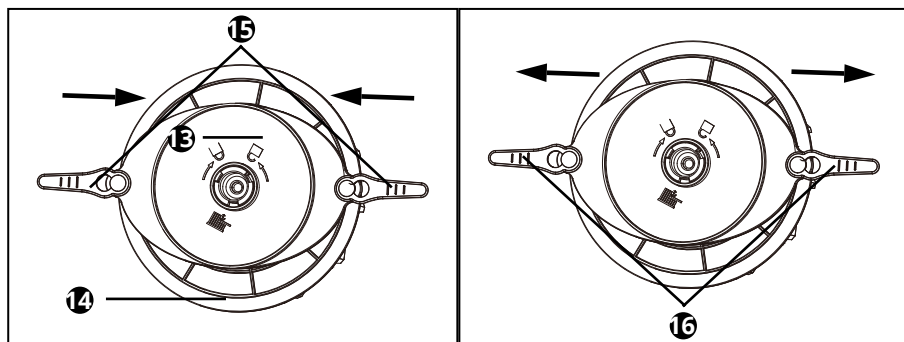

- Disconnect from the mains power supply and wait until the cutting head 13 has stopped rotating.
- Turn the mower over and rest it carefully on its side.
- Push the plastic blade 15 towards the centre of the cutting head 13. Lift the plastic blade away from cutting head.
- Fit new plastic blades into the slots 16 at each side of the cutting head and pull into place.



WARNING! Ensure plastic cutters are correctly located. Never fit a metal bar blade to this product. If the blade has broken, please wear gloves or suitable protection before handling the blade.

General maintenance and storage

- Replace plastic blades, bolts, nuts or screws, whenever necessary.
- Ask a technical servicing specialist to clean the air filter thoroughly and carry out any other service or repairs required.
- Store in a dry place, out of reach of children.

PLUG REPLACEMENT

If you need to replace the fitted plug, then follow the instructions below.

IMPORTANT! The wires in the mains lead are coloured in accordance with the following code:

Blue – Neutral

Brown – Live

As the colours of the wire in the mains lead of this apparatus may not correspond with the coloured marking identifying the terminals in your plug, proceed as follows.

1. The blue wire must be connected to the terminal marked 'N' or coloured black.
2. The brown wire must be connected to the terminal marked 'L' or coloured red.

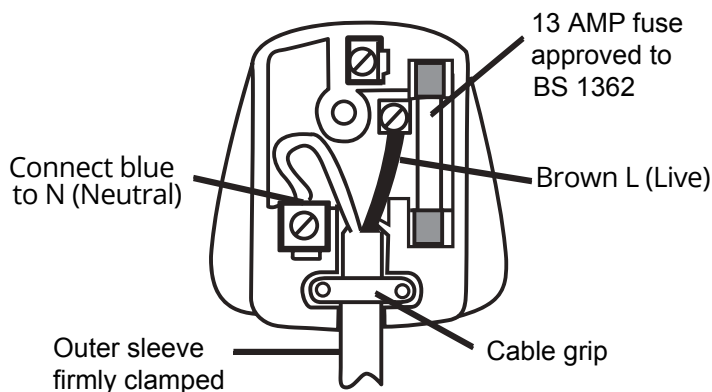

WARNING: Never connect live or neutral wires to the earth terminal of the plug.

Only fit an approved 13 Amp BS 1363 or BS 1363/A plug and the correctly rated fuse.

If in doubt, consult a qualified electrician.

NOTE: If a moulded plug is fitted and has to be removed, take great care in disposing of the plug and severed cable. It must be destroyed to prevent engaging into a socket.

TROUBLESHOOTING

General Troubleshooting

The following table provides solutions to common problems encountered with the mower.

Fault/malfunction	Cause	Remedy
Mower does not start	No power at mains socket	Check the fuse, switch, socket, cable, wire and have any repairs carried out by a qualified electrician
	Defective on/off switch	Repair by a qualified technician required
	Worn carbon brushes	
	Defective motor	
Poor floatation	Fan is blocked by grass	Disconnect from mains and clean the deck and the fan
Poor collection	Cut height too low	Raise the cutting height
	Grassbox fitted incorrectly	Fit the grassbox correctly
Excessive vibration	Plastic blades broken or missing	Replace plastic blades
	Plastic blades fitted incorrectly	Fit the plastic blades correctly

TECHNICAL DATA

Technical Data Table

Specification	Value
Model	MEH1129B
Voltage	220-240V~ 50Hz
Power input	1100W
Motor speed	8300 min ⁻¹
Cutting width	29cm
Cutting height adjustment	10mm, 33mm; 2 levels
Volume of grass collector	15 litres
Rear roller size	38mm
A weighted sound pressure L_{pA}	87 dB(A), K=3dB(A)
A weighted sound power L_{WA}	93.3 dB(A), K=2.90dB(A)
The guaranteed sound power level L_{WA}	96 dB(A)
Vibration at the handlebars ahv	< 2.5 m/s ²
Insulation protection class	□ / II

RECYCLING AND DISPOSAL



Waste electrical products should not be disposed of with household waste. Please recycle where facilities exist. Check with your local authority or retailer for recycling advice.

GETTING HELP

If you need help or have damaged or missing parts, call the Customer Helpline on **0343 515 1905**.

WARRANTY

This product is covered by a 12 month warranty.

The warranty covers any manufacturing defect in materials, workmanship and finish.

Any claim under this warranty must be made by going to your nearest Homebase store, taking your proof of purchase with you, and claims must be made within 12 months of the date of purchase.

We will offer you a free repair of the item where this is possible, or a replacement or a refund. Your statutory rights remain unaffected, in particular any rights you may have under the Consumer Rights Act 2015.

This warranty is given by HHGL Limited, MK9 1BA; HHGL (ROI) Limited, D02 X576.

Please note: This warranty does not apply to products misused or neglected and only covers domestic use. It does not apply to commercial use of the product.