

POWERBASE

2800W Electric
Silent Shredder 577147

Instruction Manual

IMPORTANT!

Please read these
instructions fully before
starting assembly.



These instructions contain important information that will help you get the best from your product, ensuring it is assembled correctly and safely. If you need help or have damaged or missing parts, call the Customer Helpline on 0343 515 1905.

Contents

Safety Information	3
In the Box	12
Assembly	14
Operating Instructions & Tips	15
Maintenance	18
Working Methods	21
Troubleshooting	24
Technical Data	25
Disposal	26
Getting Help	26
Warranty	27

Safety Information

Warning symbols

Important - Please read these instructions fully before starting assembly.

The following warning symbols appear throughout this manual and indicate the appropriate safety measures you should take when assembling and operating the shredder.



Read the instruction handbook before operating this machine.



Wear eye and ear protection (PPE).



Wear hand protection.



Do not expose to moisture.



Switch off and remove the plug from the mains before adjusting, cleaning or if the cord is entangled or damaged.



Danger! Rotating blades. Keep hands and feet out of openings while the machine is running.

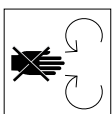

Wait until all machine components have completely stopped before touching them.



WARNING! Danger from flying objects. Keep your distance from the funnel and ejection area, Keep bystanders away.



WARNING! Electric shock hazard. Before carrying out adjustments or maintenance, switch off and remove the plug from the mains.



Guaranteed sound power level data (99dB) in accordance with Directive 2000/14/EC.

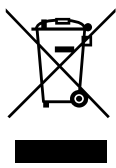

Recycle unwanted materials instead of disposing of them as household waste. All tools, hoses and packaging should be sorted, taken to the local recycling centre and disposed of in an environmentally safe way.

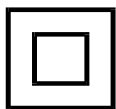

Class II equipment.

IP24

Protection against contact with the fingers and solid foreign bodies with $\varnothing > 12\text{mm}$, as well as protection against splashed water from all directions.

P40

Machine operates intermittently. Each cycle comprises a period of operation of 40 seconds at rated power input and a period of 60 seconds with the machine at no load.

CE

The product complies with the applicable European directives and an evaluation method of conformity for these directives was done.

**UK
CA**

The product complies with the applicable UK directives and an evaluation method of conformity for these directives was followed.

 **IMPORTANT!** When using the equipment, the following safety precautions must be followed to avoid injuries and damage.

- Read all operating instructions carefully and comply with them. It is important to understand these instructions and to acquaint yourself with the machine, its correct usage and all safety requirements.
- Keep this manual in a safe place so that the information is available to the operator at all times.
- If you give the equipment to any other person, give them these operating instructions as well.
- We accept no liability for damage or accidents which result from non-compliance with these instructions.

Observe local noise and other regulations.

 **CAUTION!** When using mains-powered tools, observe the following basic safety measures for the prevention of electric shocks and the risk of injury and fire:

 **Training:** Become familiar with the instruction manual before attempting to operate this equipment.

- This device must not be used by people (including children) with reduced physical, sensory or mental capabilities or lack of

experience and knowledge, or people unfamiliar with these instructions; local regulations may restrict the age of the operator.

- Keep children and pets at a safe distance away from the device. Children must be supervised in order to ensure that they do not play with the equipment.
- Never allow children or others who are not familiar with the operating instructions to use the shredder. Local regulations may stipulate the minimum age of the user of this type of machinery.
- Never use the shredder with other persons or animals nearby.
- When using the shredder, wear appropriate hearing and eye protection at all times.
- Wear appropriate protective clothing, such as protective gloves, firm footwear and long trousers. Do not wear loosely fitting clothes, or clothes with dangling cords or belts.
- Only use the shredder in the open (that is, away from walls or other rigid structures) and on a firm, level surface.
- Do not use the machine on a paved or gravelled area, or that which could be damaged by ejected material.
- Before you start up the shredder, check that all of the nuts, bolts and other fastenings are tight. Covers must be fastened properly and in good working order. Replace any

damaged or illegible stickers.

- Do not leave the shredder working unattended. Keep it in a safe, dry place out of children's reach.
- Only supply power to the equipment through a circuit protected by an RCD, with a maximum trip current of 30mA.
- When servicing the cutting means, please be cautious as the blade(s) can still be moved by a manual starting mechanism, even though the interlock feature of the guard stops the power source from working.
- Shut off the power unit before attaching or removing the collection box.
- Keep all guards and deflectors in place and in good working condition.

Operating and maintenance safety

- Make sure that the hopper funnel is empty before you start the shredder.
- Keep your head, hair and body away from the intake opening.
- Do not reach into the hopper funnel during operation. The shredder will continue to run for a short period after you switch it off.
- Always make sure you are standing in a firm, balanced position. Do not lean forwards, and never stand above the shredder when inserting materials.

- Make sure that the material inserted into the shredder does not contain hard objects made of metal, stone, glass or similar.
- Do not use the shredder in the rain or in bad weather. Work in daylight or under good artificial lighting conditions.
- Do not operate the shredder when you are tired or distracted, or under the influence of alcohol or medication. Always take a break when you need one and be sensible about how you work.
- Disconnect from the mains supply (i.e. remove the plug from the mains socket) in the following circumstances:
 - when you are not using the device
 - transporting the shredder or leaving it unattended
 - before releasing a jammed blade
 - when you are checking the device, cleaning it or removing blockages
 - when you are carrying out cleaning or maintenance work or replacing accessories
 - before moving or lifting the shredder.

Note: If the shredder is making unfamiliar noises or vibrations, or has struck a foreign object, disconnect the power cable and ensure any damage is checked and/or cleared before starting up again.

- Do not allow shredded material to accumulate near the ejection area. This may otherwise hinder proper ejection and force the material back up through the funnel.
- Do not transport or tip the shredder with the motor running.
- Keep hands, other body parts and clothing out of the filling chamber and ejection channel, and away from other moving parts.
- In the event of blockages in the machine intake or ejection channel, switch off the motor and disconnect the machine from the mains before removing leftover material in the intake opening or ejection channel. Ensure that the motor is free of rubbish and other accumulations in order to safeguard the motor from damage or possible fire.

 **CAUTION!** The following states how damage to the shredder and possible injury to people can be avoided:

- Handle the unit with care. Clean the ventilation slots regularly, and follow the maintenance instructions.

- Do not overload your device. Work only within the indicated range of performance. Do not use low power machines for heavy-duty work. Do not use your device for purposes for which it has not been designed.
- Only switch the shredder off once the hopper funnel is completely empty. The shredder may otherwise clog up and not be able to start afterwards.
- Do not attempt to repair the shredder yourself unless you are qualified to do so.

Electrical safety



CAUTION! The following states how to avoid accidents and injuries due to electric shock:

- Only use extension cables that have been approved for outdoor use and are earthed and splashproof. The core diameter for extension cables measuring up to 25m must be at least 1.5mm², and 2.5mm² for cables longer than 25m. Always roll the whole cable off the reel before use. Check the cable for damage. If the cable is damaged whilst the shredder is working, disconnect the mains plug from the power supply immediately and then check the extent of the damage. Never use the shredder if the cable is not in perfect condition.

- Do not unplug the shredder by pulling on the cable, only pull the plug itself. Keep the cable away from heat, oil and sharp edges.
- Do not use the appliance if the on/off switch does not work properly. Always have a damaged switch repaired by a qualified technician.
- Do not touch the mains power supply cable under any circumstances.
- If the power cable for this equipment is damaged, it must be replaced by a qualified person in order to prevent hazards.

General Description

Functional description

The silent shredder is equipped with a powerful motor and motor brake, overload protection with an auto-reverse system, and restart prevention for additional safety. A blade cylinder system is used for cutting, which works quietly and automatically draws in the shredding material. The sturdy chassis ensures a stable standing position with good mobility.

In the Box

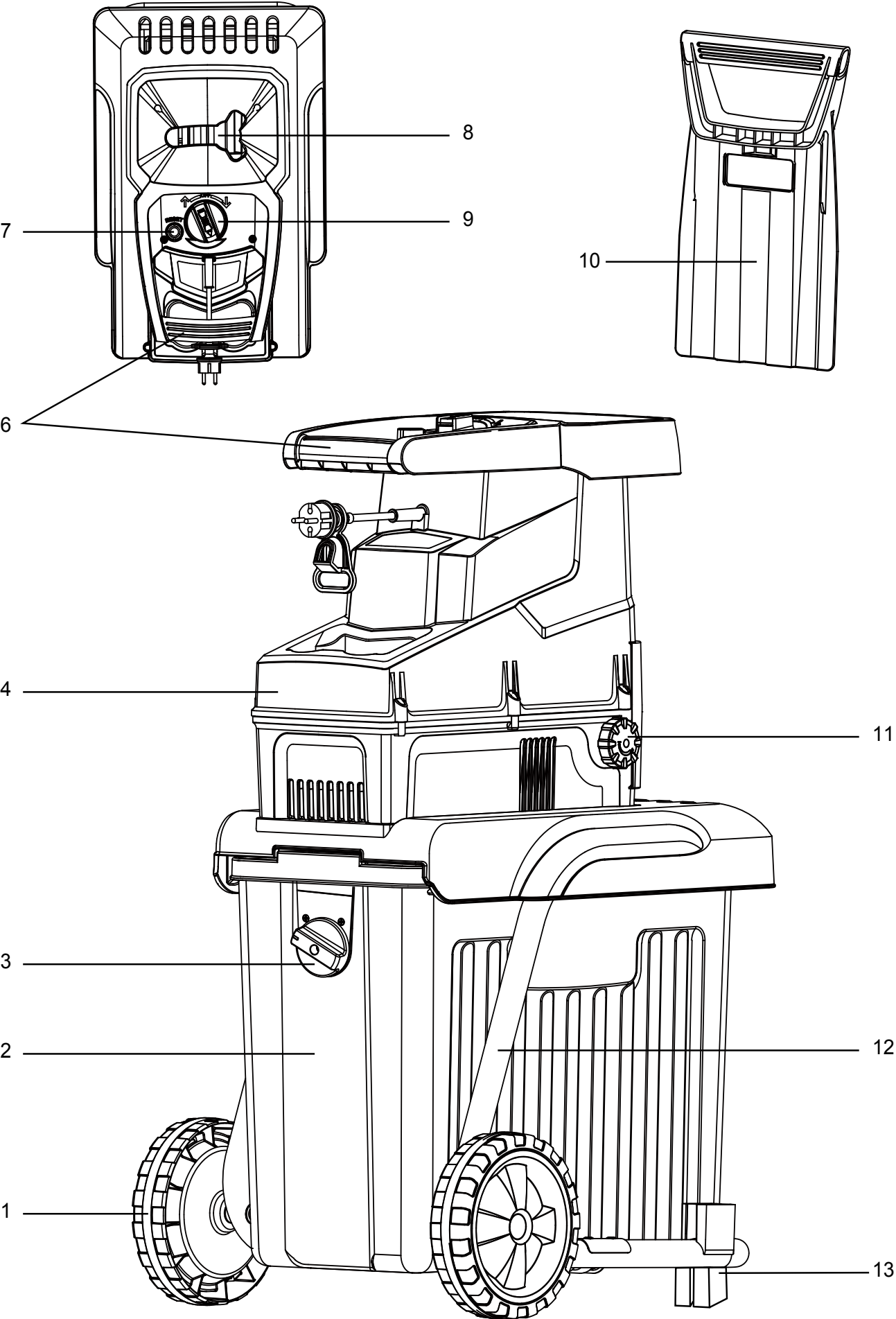

Parts

1	Wheels	8	Hopper funnel feed inlet
2	Collection box	9	Operating mode selection switch
3	Collection box safety switch	10	Feeder
4	Shredder unit	11	Cutting blade adjuster knob
5	Mains cable	12	Chassis
6	Transport handle	13	Feet
7	Reset switch		

Assemble

Step 1 - Unpacking

- Remove the shredder from the packaging.
- For compact storage and transportation, the shredder unit can be stored in the collection box. Before assembly, pull the collection box **2** out of the chassis **12** and take out the shredder unit and accessories (Fig. 1).

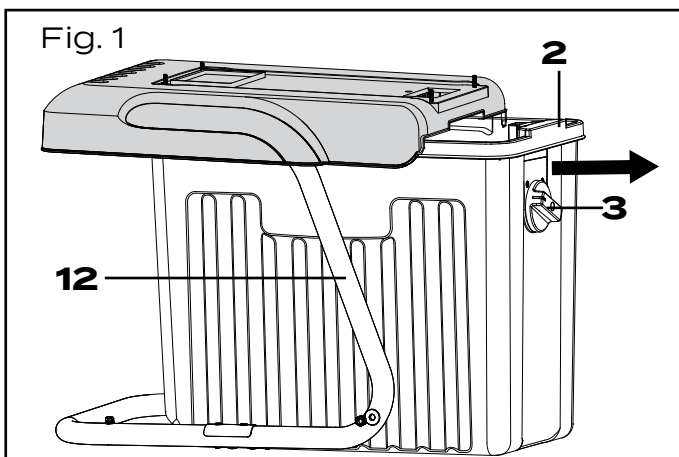

Step 2 - Assembling the shredder

- To assemble the two transportation wheels **1**, insert the screw provided through the central wheel hub, washer, chassis and washer, then secure with the bolt provided on the inside of the frame. Repeat this step for each wheel. The two wheel covers can now be clipped onto the wheel hub.
- Screw on the two stabilising feet **13** to the chassis **12** (Fig. 2).
- Fix the shredder unit **4** onto the top of the chassis **12** with the four screws enclosed.
- To insert the collection box, ensure the safety switch is in the 'OFF' position **3**. Push the collection box into the chassis, with the safety switch at the rear of the machine. The collection box can only be fitted in one direction.
- To secure the collection box into position, rotate the safety switch clockwise to the 'ON' position **3**. This is a safety device: ensure the collection box is firmly connected in position; otherwise, the shredder motor will not function.

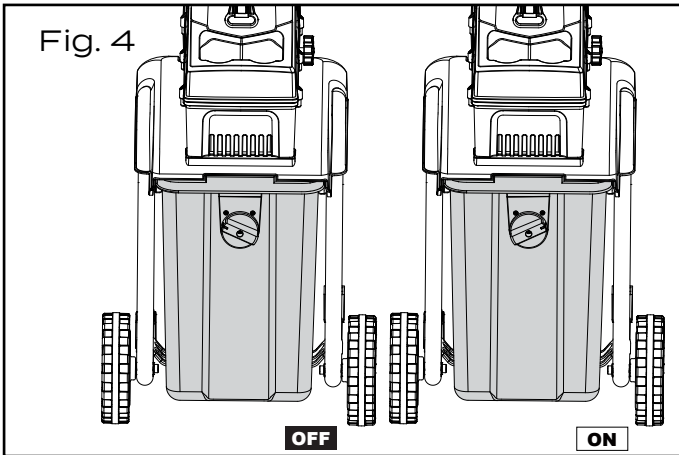
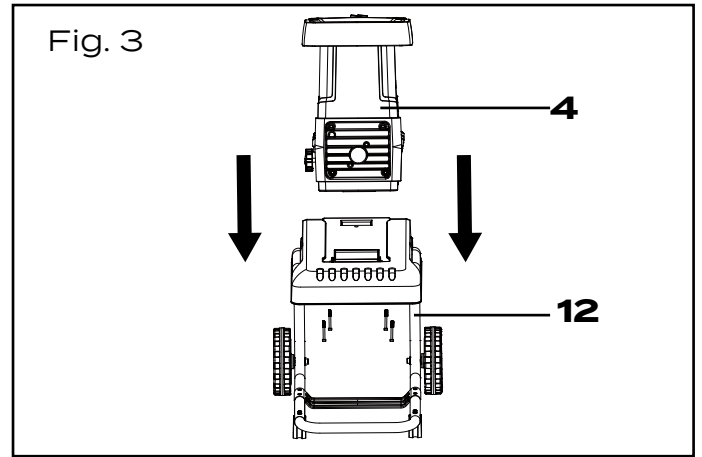
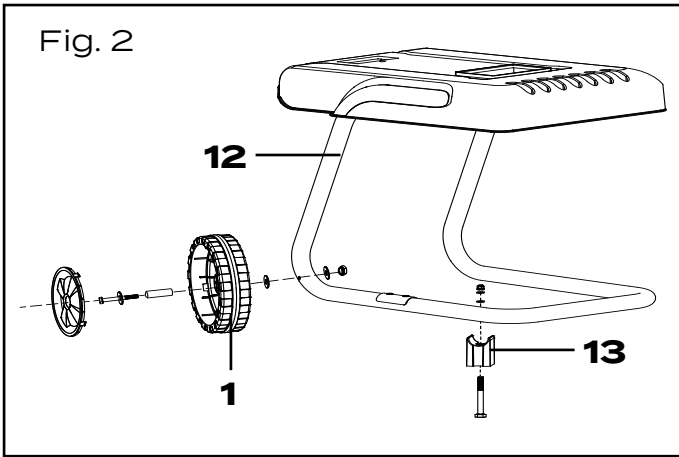

Operating Instructions & Tips

Operation

i Before starting the device, make sure that the shredder unit is firmly attached to the chassis, and the collection box and safety switch are in the correct positions.

The shredder will not switch on unless the collection box and the safety switch are in their correct positions.

Switching the shredder on and off

i Make sure that the mains power voltage corresponds to the information on the rating label on the shredder. If your shredder is fitted with a long mains cable, you can plug this directly into a suitable power supply, using an RCD device if necessary.

Make sure that the hopper funnel is empty before starting.

The collection box must be fitted and the safety switch on the collection box must be firmly engaged in the 'ON' position (up) or the motor will not start.

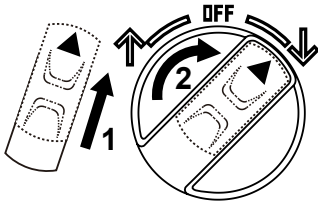

To switch on: Engage the safety lock in the centre of the operation selection switch by pushing forwards. Once engaged, turn the operation switch clockwise into the 'ON' position.

To switch off: Turn the operating selection switch counter-clockwise to a central position.



CAUTION! The sharp blades may continue to rotate for a few seconds after switching off the machine.

Emptying the collection box



The collection box may fill unevenly. Do not allow the shredded material to accumulate near the ejection area.

- Switch the shredder off.
- Release the collection box by disengaging the safety switch and rotating to the 'OFF' position.
- Remove the collection box from the chassis and empty it.
- Make sure that the area around the safety switch is free of dust and wood chippings before you re-fit the collection box.
- Re-fit the collection box into the chassis and engage the safety switch by rotating to the 'ON' position.

Overload protection

In the event of the machine being overloaded, e.g. due to branches that are too thick, the shredder may switch off automatically. To switch the machine back on, turn the operating mode selection switch to the central 'OFF' position and press the reset switch ⑦.

Engage the safety lock in the centre of the operation selection switch by pushing forwards. Once engaged, turn the operation switch clockwise back into the 'ON' position.

Restarting and using the blade reversing mechanism

After switching off automatically as a result of overload, the equipment may not restart automatically if material remains trapped in the cutting mechanism.

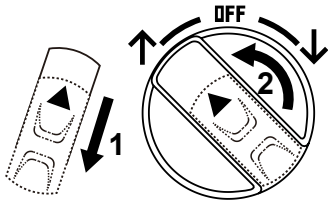

To switch back on, turn the operating mode selection switch to the central 'OFF' position.

Press the reset switch.

Release the rectangular safety lock (by pulling it back towards the handle), then turn the round knob to the left to cause the cutting mechanism to work in reverse for a few seconds and release any thick branches that may have caused the blockage. Stop the machine then remove these obstructions carefully from the feed hopper and discard them if too big.

Switch the device back on as described above.

Use the feeder **7** to help feed material down the funnel as necessary.

Maintenance

Blade adjustment

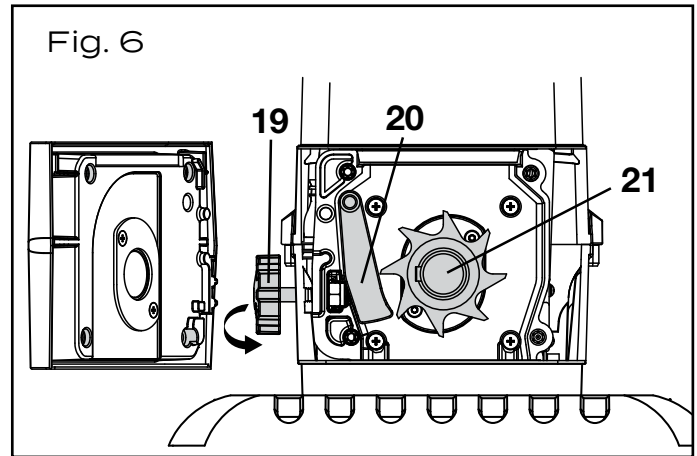
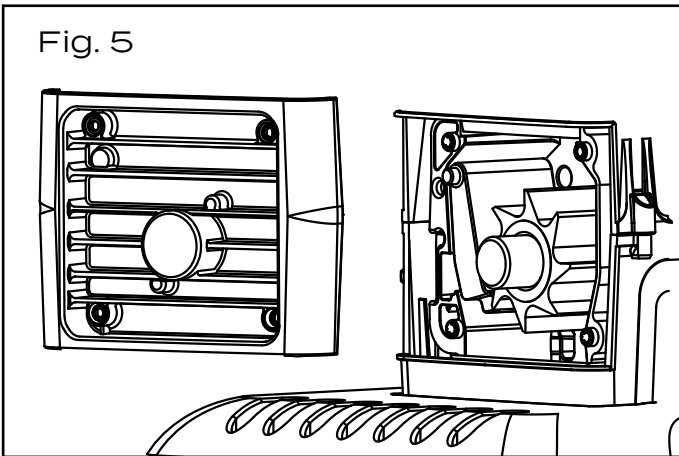

The pressure plate – what is it?

- The pressure plate **20** is used on silent shredders to finely adjust cutting performance and to improve cutting performance as the roller blade **21** and pressure plate wears.
- During adjustment, the pressure plate can be moved towards or away from the rotating roller blade. The pressure plate can be moved away from the roller blade to help clear blockages. During adjustment, to improve cutting performance, the pressure plate is moved towards the rotating roller blade.
- The roller blade is designed to cut into the pressure plate to ensure that there is no gap between the blade and the plate. The pressure plate is sacrificial to the roller blade and will be reduced in size over time. If you regularly adjust the pressure plate then the branches to be shredded will be cut through properly. Eventually, over time, you may need to replace the pressure plate.

Advancing the pressure plate to improve cutting performance

To do this, the pressure plate is advanced towards the roller blade while the roller blade is rotating. This ensures that only the circular path of the tips of the blade cut into the pressure plate.



IMPORTANT! Do not advance the plate while the blade is stationary. If the pressure plate is adjusted while the blade is stationary, the plate can be positioned between the tips of 2 of the blades and too far within the blades and the circular path of the blade tips. This could damage the pressure plate or the shredder.

Using the adjustment knob correctly

- Ensure the shredder inlet is free from material to be shredded.
- Start the machine normally in the down direction, this is the direction required to shred material.
- The shredder roller blade should rotate freely; it has a low speed of rotation only once per second.
- Slowly rotate the adjustment knob **19** clockwise a ½ turn. The pressure plate is advanced towards the blade while the blade is moving.
- If the roller blade continues to rotate without a grinding noise, advance another ½ turn.
- When you here a grinding noise, the pressure plate is being cut by the roller blade; your shredder is now correctly set up for a good cut. You should see small aluminium shavings from the pressure plate in the collection box.
- Check cutting performance by feeding a woody branch into the shredder - it should be cut through correctly into pieces approximately 3cm in length.

Removing blockages



WARNING! Always switch the product off, disconnect it from the power supply and let the product cool down before performing inspections, maintenance and cleaning work!

In case of more stubborn blockages, you may have to clear material from inside the cutter housing. Proceed as follows:

- Remove the four Allen screws **14** on the housing cover **16**.
- Remove the cover. This may require light jerking movements.

- Remove any further blockage from the equipment.
- When fitting the cover **16** back on, ensure it is fitted correctly so that the blade shaft **18**, the pressure plate rod **17** and the four recesses **15** for the Allen screws are all correctly aligned and fit smoothly into the recesses on the cover. Ensure that the cutting pressure plate is positioned correctly.
- Screw on the housing cover **15** firmly with the four Allen screws **14**.

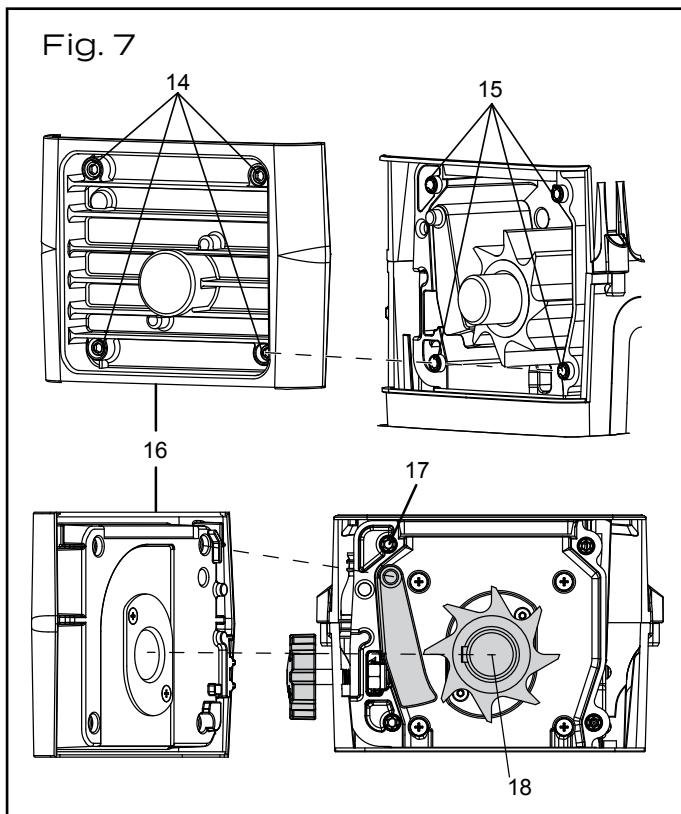

Working Methods

General working instructions



Keep all body parts at a safe distance away from the shredder when in use; long branches and other materials may move unexpectedly.



Wear ear and eye protection.



Wear hand protection (PPE).

- The shredder will not operate if the collection box is not correctly fitted. Ensure the safety switch on the box is in the 'ON' position.
- When feeding branches into the unit, keep holding them firmly until they are automatically drawn in.
- Adapt to the speed of the shredder and avoid overloading the unit. Overloading will cause it to slow down, possibly overheat and shut down.
- To avoid the unit clogging up, mix freshly cut branches or leafy matter with drier materials, such as twigs.
- To prevent the blade from becoming blunt quickly, remove mud and stones from the roots before shredding.
- Do not shred but directly compost all soft and wet material.
- Keep a couple of dry branches to use for cleaning the unit at the end.
- Do not turn off the unit until all the material has passed the blades. Remaining material may otherwise block the blade when you restart the unit.

Maintenance and cleaning precautions



WARNING! Before performing any inspections, maintenance or cleaning work, always switch off the product, disconnect it from the power supply and let it cool down.



Wear hand protection when working on the blade cylinder.

General cleaning and servicing

- Do not spray water onto the shredder. Electric shock hazard.
- Always keep the shredder, wheels and air vents clean. Use a brush or cloth to clean it, avoid cleaners and solvents.
- Always check the shredder guards to ensure they are not worn down or damaged, and that they are firmly attached before use. Check that the nuts, bolts and screws are tight.
- Check the covers and guards for damage and improper attachment. If necessary, change the components.
- Keep the shredder in a safe, dry place out of children's reach. Do not cover the shredder in nylon bags, as moisture may develop.

Plug replacement

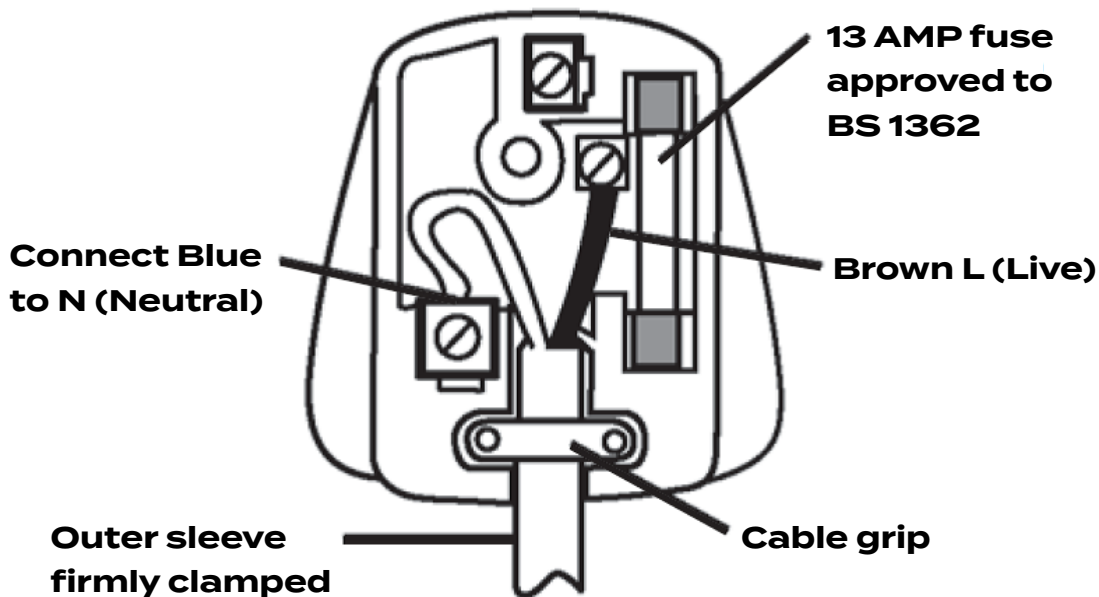

If you need to replace the fitted plug, then follow the instructions below.

⚠ IMPORTANT! The wires in the mains lead are coloured in accordance with the following code:

Blue – Neutral

Brown – Live

As the colours of the wire in the mains lead of this apparatus may not correspond with the coloured marking identifying the terminals in your plug, proceed as follows:

The blue wire must be connected to the terminal marked 'N' or coloured black.

The brown wire must be connected to the terminal marked 'L' or coloured red.

 **WARNING!** Never connect live or neutral wires to the earth terminal of the plug.

Only fit an approved BS 1363 or BS 1363/A plug and correctly rated BS 1362 13 Amp fuse. If in doubt, consult a qualified electrician.

NOTE: If a moulded plug is fitted and has to be removed, take great care in disposing of the plug and severed cable; it must be destroyed to prevent it being accidentally plugged into a power socket.

Storage

For convenient storage, the shredder unit can be put inside the collection box once disassembled. To do this, turn the shredder upside down and rest it carefully on the hopper. Remove the four screws holding the base to the shredder body unit.

Troubleshooting

General troubleshooting

The following table provides solutions to common problems encountered with the shredder:

Fault	Possible cause	Solution
Motor will not start	Collection box not fitted correctly	Push the collection box firmly to its correct position and place the safety switch on the box to the 'ON' position
	Overload protection tripped	To switch back on, start by turning the operating mode selection switch to the 'OFF' position. Press the reset switch. Switch the device back on
	No mains power supply	Check the socket, cable, lead and plug for damage and, if necessary, have any damage repaired by qualified repair personnel
Garden waste is not drawn in	Cylinder running in reverse	Change rotational direction using the operation mode selection switch
	On/Off switch is defective	Contact telephone helpline
	Shredding material is too soft	Insert wood or shred dried branches
	Shredder blade remains jammed	Clear the jam (see section on operation)
Shredding material comes out in chains	Pressure plate is incorrectly adjusted	Re-adjust the pressure plate (see section on adjusting the pressure plate)

Technical Data

Technical data table

Specification	Value
Model	SDS2810
Nominal voltage	220-240V~ 50Hz
Nominal power intake	2800W(P40)
Safety class	II/ 
Degree of protection	IP24
Shredding capacity	max. 42mm
Collection box content	60 litres
Weight	22kg
Sound power level measured (L_{wa})	96.3dB(A) KwA=2.4dB(A)
Guaranteed	99dB(A)

The maximum branch thickness that can be shredded is dependent on the type of wood and the quality of the material being cut.

For hard wood (e.g. oak/beech branches), the maximum branch thickness that can be shredded is less than for soft wood (e.g. pine/spruce wood).

For dry or knotted wood, the cutting thickness may also be less.

The sound levels have been determined in accordance with noise measuring process EN 13683:2009-09, appendix F.

The equipment is intended for use only in premises having an eliminate current capacity equal to or greater than 100A per phase supplied from a distribution network having a nominal voltage of 220-240V. You may need to check with your electricity provider if in any doubt.

Noise and vibration values were determined according to the standards and stipulations mentioned in the declaration of conformity.

Further technical or cosmetic changes may be carried out by the manufacturer without notice, due to ongoing product improvement programmes. References made in this manual may therefore sometimes vary.

Legal claims, which are made on the basis of the instruction manual, cannot thus be considered as valid.

Disposal

Disposal and recycling



Recycle unwanted materials instead of disposing of them as household waste. All tools, hoses and packaging should be sorted, taken to the local recycling centre and disposed of in an environmentally safe way.

Getting Help

If you need help or have damaged or missing parts, call the Customer Helpline on **0343 515 1905**.

Warranty

This product is covered by a 3 year warranty.

The warranty covers any manufacturing defect in materials, workmanship and finish.

Any claim under this warranty must be made by going to your nearest Homebase store, taking your proof of purchase with you, and claims must be made within 3 years of the date of purchase.

We will offer you a free repair of the item where this is possible, or a replacement or a refund. Your statutory rights remain unaffected, in particular any rights you may have under the Consumer Rights Act 2015.

This warranty is given by HHGL Limited, MK9 1BA; HHGL (ROI) Limited, DO2 X576.

Please note: This warranty does not apply to products misused or neglected and only covers domestic use. It does not apply to commercial use of the product.