

**Important** - Please read these instructions fully before using  
If you need help please call our **Customer Services** on 0345 077 8888

## Contents

Section	Page
Parts and Component list	2
Safety Information	3
Maintenance	3
Installation	4

**PRODUCED FOR HOMEBASE LTD**

**AVEBURY, MILTON KEYNES, MK9 2NW**

**Homebase.co.uk**

**TEL 0345 0778888**

# Parts and Components Listing

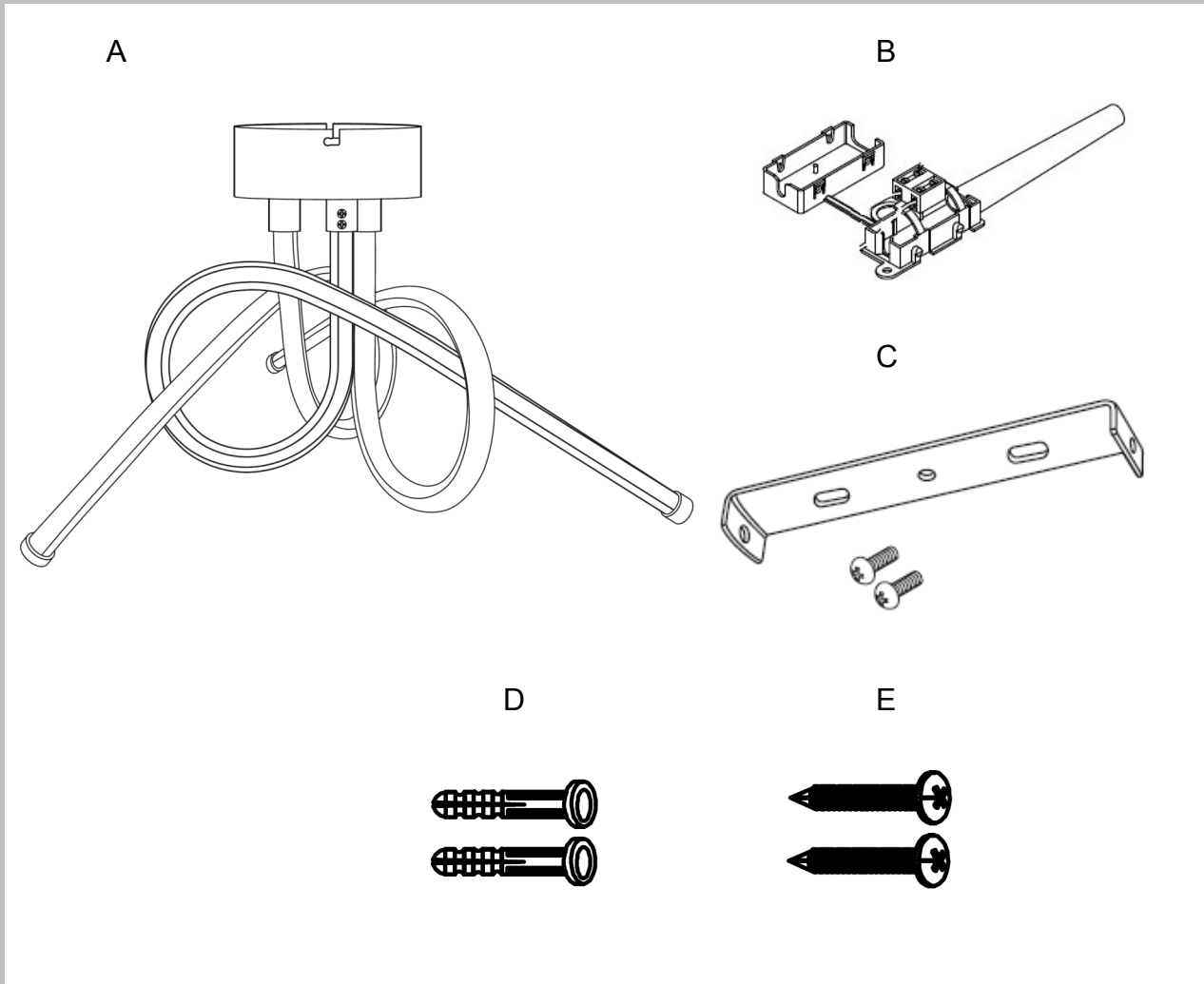

- A. Fitting x1 (Pre-wired)
- B. Connector block x1 (enclosed)
- C. Fixing bracket with side screws x1 (Pre –fitted)
- D. Ceiling plugs x 2
- E. Fixing Screws x 2

# Safety Information

**IMPORTANT** – Please read these instructions fully before installation and keep for future reference

For your safety, this product must be installed in accordance with local building Regulations. If in any doubt, or where required by law, consult a competent person who is registered with an electrical self-certification scheme. Further information is available online or from your local authority

**IMPORTANT** -This product has been designed for non-professional, domestic use only.

**IMPORTANT** - Carefully unpack and examine the product for any damage. If you think there is a defect, **do not** use the product and contact our customer services on **0345 077 8888**.

**IMPORTANT** - Dispose of all packaging correctly and responsibly and in accordance with all local laws and regulations. Never leave packaging components within reach of children as they can be a source of danger.

**IMPORTANT** - Electrical connections must be carried out by a suitably qualified person and in accordance with all relevant local building and installation regulations. If in doubt consult a qualified electrician.

**IMPORTANT** - This fitting is not suitable for Dimming.

**WARNING** - not suitable for mounting on flammable surfaces.

**WARNING** - The luminaire should be positioned so that prolonged staring into the luminaire at a distance closer than 0.2m is not expected.

**WARNING** - Always shut off power to the circuit before starting Installation work.

**IMPORTANT** - The LEDs are not replaceable, when the lamps reach the end of their life the whole luminaire shall be replaced.

**WARNING** - This is a Class 2 product and does not requires an earth connection. This fitting must be permanently wired into the electric system.

**WARNING** - Do not modify or alter any product before or after installation. This may render the product un-safe.

**WARNING** - Accessible parts become hot during use, young children **must** be kept away.

**WARNING** - This product is not intended for use by persons (including children) with reduced physical, sensory and mental capabilities, or lack of experience and knowledge, unless they have been given supervision or instruction concerning use of the product by persons responsible for their safety.

**WARNING** - Children should be supervised to ensure that they do not play with the product.

**CAUTION** - Ensure the power is switched off before cleaning or carrying out any maintenance.



## Maintenance

### Maintenance

**CAUTION!** Always disconnect power supply when servicing or cleaning.

#### Cleaning

- Use a clean dry soft or slightly damp cloth.
- Do not use abrasive cloths or polishes as this may cause damage to the product.

# Installation

## Installation

**IMPORTANT !** - Electrical connections must be carried out by a suitably qualified person and in accordance with all relevant local building and installation regulations. If in doubt consult a qualified electrician.

### DIA.1

1. Using fixing bracket as a template, mark suitable holes on the ceiling, using a drill, drill two holes previously marked taking care not to damage the supply cable and insert suitable ceiling plugs provided.
2. Secure the fixing bracket joist to the ceiling using fixing screws provided.
3. Connect the mains supply wires to the terminal block, and ensure all connections are tight and there are no loose strands (see DIA.2).
4. Place the fitting over the fixing bracket.
5. Using the side screws, secure the fitting in place.

Switch on the mains supply power and test the fitting.

### LED INFORMATION:

- The Fitting is not suitable for dimming.
- The LEDs are not replaceable, when the lamps reach the end of their life the whole luminaire shall be replaced.

DIA.1

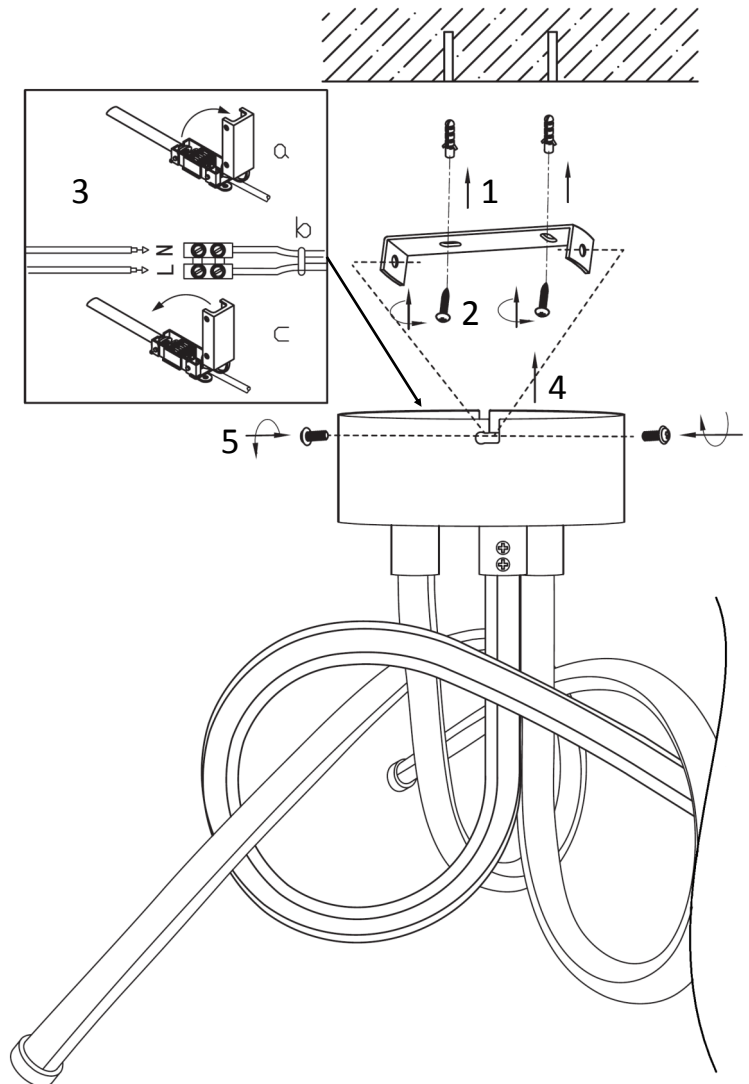

DIA.2

