

## SPUTNIK EASY FIT PENDANT

471126

Installation and User Instructions—Please Keep for Future Reference



**Important** –Please read these instructions fully before using  
If you need help please call our **Customer Services** on 0345 077 8888

**Contents: Lamp holder is NOT supplied !**

Section	Page
Parts and Component list	2
Safety Information	3
Maintenance	3
Installation	4

**PRODUCED FOR HOMEBASE LTD**

**AVEBURY, MILTON KEYNES, MK9 2NW**

**Homebase.co.uk**

**TEL 0345 0778888**

# Parts and Components Listing

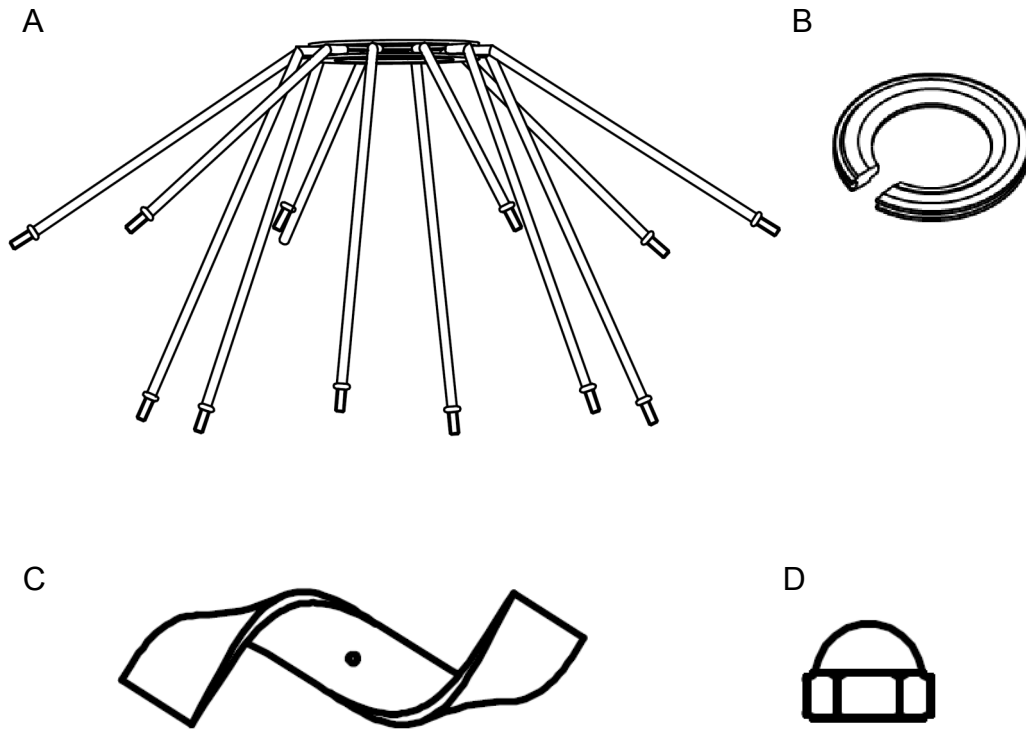

A: Pineapple fitting x 1 (dressed)

B: Reducer ring fitted into the frame x 1

C: Acrylic Ribbons x 12

D: Decorative Nut x 12

# Safety Information

**IMPORTANT** – Please read these instructions fully before installation and keep for future reference

Your product is produced in conformity with all relevant safety regulations relating to electrical appliances. If in doubt about fitting this product, please consult a qualified electrician.

**IMPORTANT** - This product has been designed for non-professional, domestic use only.

**IMPORTANT** - Carefully unpack and examine the product for any damage. If you think there is a defect, **do not** use the product and contact our customer services on: **0845 077 8888**.

**IMPORTANT** - Dispose of all packaging correctly and responsibly and in accordance with all local laws and regulations. Never leave packaging components within reach of children as they can be a source of danger..

**IMPORTANT** - Before inserting or replacing bulb(s) ensure the power is switched off and the bulb(s) have cooled down..

**WARNING** - Do not modify or alter any product before or after installation. This may render the product un-safe.

**WARNING** - Accessible parts become hot during use, young children **must** be kept away.

**WARNING** - This product is not intended for use by persons (including children) with reduced physical, sensory and mental capabilities, or lack of experience and knowledge, unless they have been given supervision or instruction concerning use of the product by persons responsible for their safety.

**WARNING** - Children should be supervised to ensure that they do not play with the product.

**WARNING** - **Do not** mount this fitting in a damp atmosphere.

**CAUTION** - Ensure the power is switched off before cleaning or carrying out any maintenance

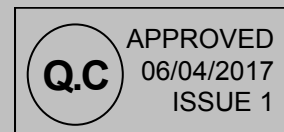

# Maintenance

## Maintenance

**CAUTION!** Always disconnect power supply when servicing or cleaning.

### Cleaning

- Use a clean dry soft or slightly damp cloth.
- Do not use abrasive cloths or polishes as this may cause damage to the product.

### Changing the bulb

**IMPORTANT!** Ensure that the bulb has cooled down before replacing.

Ensure that the power supply has been disconnected.

# Installation

## Installation

**IMPORTANT !** - Electrical connections must be carried out by a suitably qualified person and in accordance with all relevant local building and installation regulations. If in doubt consult a qualified electrician.

### Installation

1. Place the Acrylic Ribbons (C) over the metal rods and secure them in place screwing the Decorative Nuts provided (D).
2. Unscrew the bottom section of your lamp holder (NOT SUPPLIED WITH FITTING).
3. Place the threaded part of the lamp holder through the centre of the shade.
4. Re-fit the bottom section of the lamp holder to secure the shade in place.
5. Insert the bulb (NOT SUPPLIED) into the lamp holder. Please ensure the maximum wattage is not exceeded as stated on the lamp holder.

NOTE: The reducer ring is fitted into the frame for use with a normal B22 lamp holder. The shade can be fitted to a larger E27 lamp holder if required by removing the plastic reducer ring. See Dia.1.

#### REPLACEMENT LAMP

Maximum wattage – See Lamp holder

Light bulb shape - See Lamp holder

Suitable low energy lamps can be used with the shade, for example :

5 watt = 25W

7 watt = 35W

9 watt = 45W

11 watt = 60W

15 watt = 75W

20 watt = 100W

Dia.1

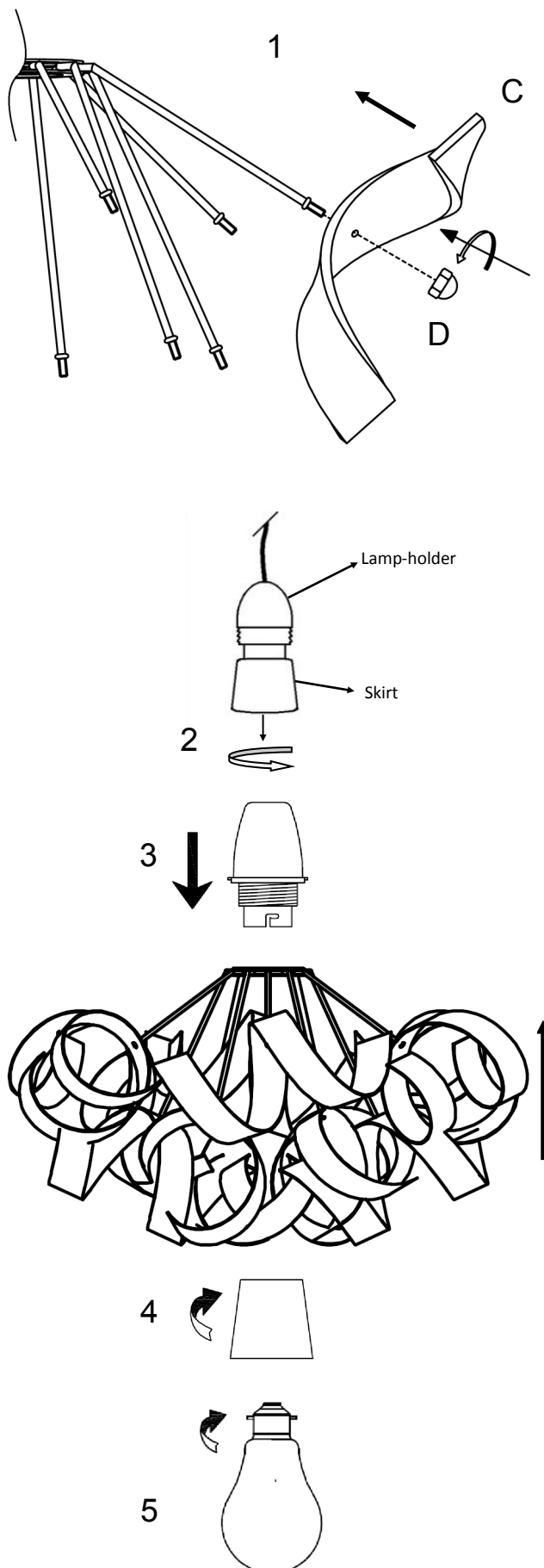
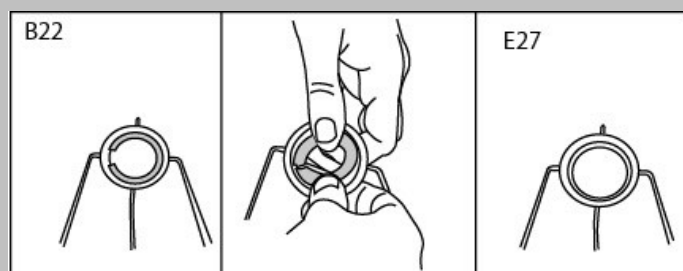

Customer Helpline 0345 077 8888