



La Hacienda

Colorado Mesh Chimenea XL

56138
V1.0

User Instructions - Please keep for future reference



Tools required (not included)



IMPORTANT! – Carefully remove any packaging before use, but retain the safety instructions.

These instructions form part of the product.

Please take note of all of the safety warnings listed in these instructions.

Please read these instructions in their entirety and retain them for future reference.

These instructions should be stored with the product.

This product is for domestic use **ONLY** and should not be used commercially or for contract purposes.

Failure to adhere to these instructions could result in property damage, personal injury or death.

Produced in PRC for La Hacienda Ltd
Hangar 27, Site C, Aston Down Airfield, Nr Stroud, Glos, GL6 8HR, UK
www.lahacienda.co.uk

WARNINGS - CAUTION!

- This product is intended **FOR OUTDOOR USE ONLY. DO NOT USE INDOORS.**
- **WARNING! - ALWAYS** keep children and pets at a safe distance from the product when in use.
- **NEVER** leave a burning fire unattended.
- **DANGER** of carbon monoxide poisoning - **NEVER** light this product or let it smoulder or cool down in confined spaces.
- **DO NOT** use this product in a tent, caravan, car, cellar, loft or on a boat.
- **DO NOT** use under any awnings, parasols or gazebos.
- **FIRE HAZARD** – Hot embers may emit while in use.
- **WARNING! - DO NOT** use petrol, white spirit, lighter fluid, alcohol or other similar chemicals for lighting or relighting. **ONLY** use firelighters that comply to EN:1860-3.
- This product is **ONLY** suitable for use with untreated wood, logs or La Hacienda HeatBlox.
- **DO NOT** use coal or charcoal in this product.
- **DO NOT** use this product on decking or any other flammable surfaces such as dry grass, wood chips, leaves or decorative bark.
- Ensure that the product is positioned at least 2m away from flammable items. Also ensure that there is a minimum overhead clearance of 2m from the top of the unit.
- **DO NOT** use this product as a furnace - **ONLY** use as a patio heater.
- **ATTENTION! - This product will become very hot. DO NOT** move it during operation.
- **ALWAYS** use the safety tool provided and heat resistant gloves to open and close the door when in use, as the door will be hot.
- This product is **NOT** intended for cooking or heating food.

CARE & USE

- Ensure that the product is positioned on a permanent flat, stable, heat resistant, non-flammable surface away from flammable items.
- Ensure that the product has a minimum of 2m overhead clearance and has a minimum of 2m clearance from other surrounding items.
- Decide on the location as above. The assembled product is heavy and it is therefore recommended that the unit is not moved once positioned and must **NOT** be moved whilst in use. If it is necessary to move it once it has cooled, please use 2 persons to lift (do not drag) the product across the floor.
- The unit may be left outside all year if a La Hacienda Weatherproof Cover is used to help protect it from bad weather.
- As this model is made from steel, the surface will age and develop surface rust as soon as it is placed outside and from first use. This is to be expected, does not affect use and is not a product fault. Please see below instructions on how to refresh the paint finish if desired.
- To help reduce surface rust, rub the product with an oily rag after each use.
- For safety reasons, always inspect your product prior to use for signs of fatigue and damage, and replace your model as and when necessary. Continuing to use a damaged unit could cause personal injury or damage to property.
- **ALWAYS** use heat resistant gloves during use and when adding fuel.

LIGHTING & REFUELLING

- This product is **ONLY** suitable for use with untreated wood, logs or La Hacienda HeatBlox.
- Prepare a stack of loosely crumpled newspaper and place on top of the log grate.
- Pile finely split dry firewood or kindling on top of the paper.
- To light the newspaper, use long safety matches or a long nosed lighter.
- Once sufficiently alight, add logs or larger pieces of untreated wood to the unit to increase the heat slowly.
- **DO NOT** overload with fuel, only one or two logs is sufficient.
- **ALWAYS** use heat resistant gloves and the safety tool when adding fuel and repositioning the door, as the unit will become very hot.
- **ALWAYS** ensure that the door is closed when in use. **ALWAYS** use the safety tool to open and close the door.
- **ALWAYS** ensure that fuel does not protrude from the front opening of the product.

EXTINGUISHING

- To extinguish – stop adding fuel and allow fire to die or douse with sand. **DO NOT** use water as this may damage the product.

STORAGE

- When not in use, and if stored outside, cover the product once it has cooled completely with a La Hacienda Weatherproof Cover.
- Remove loose paint and rust with a wire brush when needed and re-paint the product using La Hacienda High Temperature Paint.

Parts list

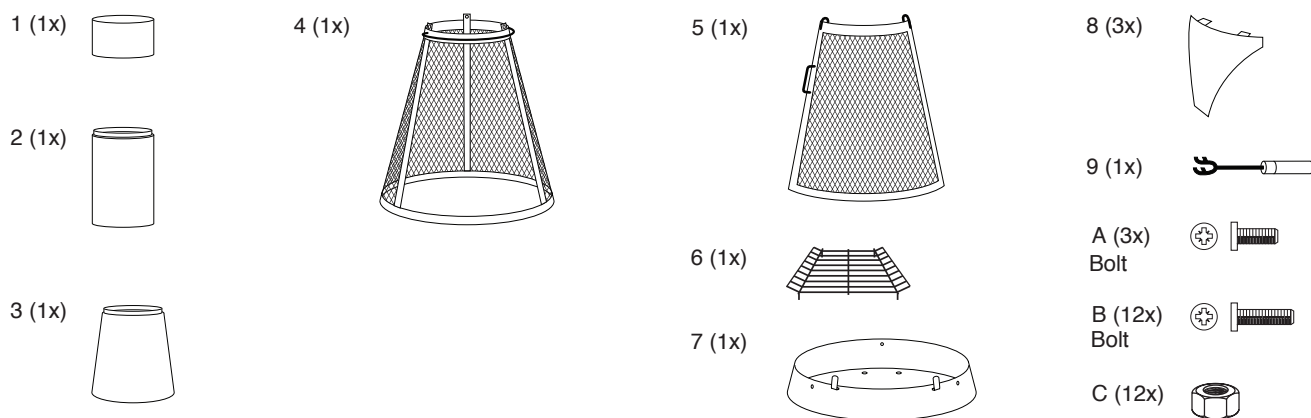

Prior to assembly, read the instructions carefully. Check all parts against the parts list.
Carry out assembly on a soft surface to avoid scratching the paint. Please retain this information for future reference.
For ease of assembly only loosely tighten bolts and then tighten fully when assembly is complete.

WARNING! - DO NOT over tighten bolts; only tighten with moderate pressure to avoid damaging the bolts or components of the chimenea.

Assembly diagram

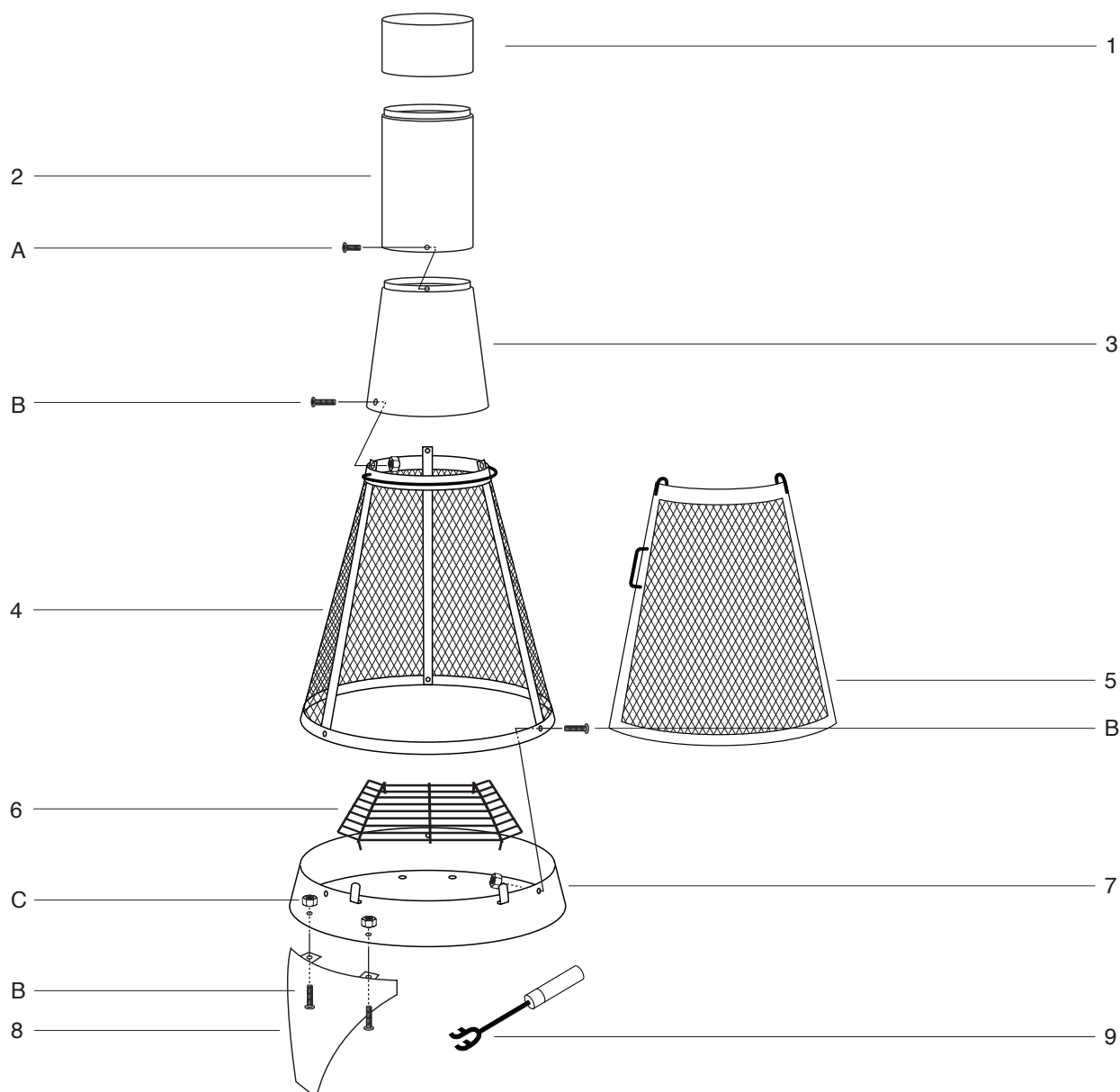

Assembly Instructions

IMPORTANT! - Remove any packaging before use, but retain the safety instructions and store them with this product.

ASSEMBLY

STEP 1 - Attach 3x legs (8) to the chimenea base (7) using 2x bolts (B) and 2x nuts (C) per leg.

STEP 2 - Attach mesh body (4) to the chimenea base (7) using 3x bolts (B) and 3x nuts (C). Ensuring the mesh body sits inside the top lip of the base.

STEP 3 - Attach the middle flue section (3) to the mesh body (4) using 3x bolts (B) and 3x nuts (C).

STEP 4 - Attach top flue section (2) to middle flue section (3) using 3x bolts (A) into pre-threaded holes. Do not over tighten.

STEP 5 - Push top ring (1) onto collar of top flue section (2).

STEP 6 - Insert log grate (6) into chimenea base (7). The position of this can be adjusted using the hand tool (9).

STEP 7 - Hang the mesh door (5) on to the top of the door ring on the mesh body (4).

The product is now ready to use, but please ensure you have read these instructions thoroughly prior to use.